

---

DANA INNOVATIONS

SPECIFICATION GUIDE 2018







## INVENT. LEAD. REINVENT.

Established in 1983, with the invention of the first in-wall speaker, Southern California-based Dana Innovations encompasses the Sonance, iPort and TRUFIG brands. Our philosophy is that great design is about attention to detail. Traditionally, technology can compromise the flow and integrity of a space. We believe in offering the custom installer and the design community the creative freedom to blend architecture and technology seamlessly in any space. With distribution in over 120 countries around the world and 18 unique product categories, each of our brands offer innovative and unique solutions for today's most discerning spaces.

SINCE 1983

WE ARE DANA INNOVATIONS







Since our beginning over thirty years ago, Dana Innovations has continued to invent, lead and reinvent, creating new categories and pushing the boundaries of technology and design. Dana Innovations is regarded as a founder of the custom installation industry, and is a driving force today.

**CEDIA LIFETIME ACHIEVEMENT:  
SCOTT STRUTHERS**

Recognizes Sonance founder Scott Struthers for inventing the in-wall speaker and major contributions in the establishment of the custom installation industry.

**CEDIA HALL OF FAME:  
SONANCE 1 SPEAKER**

Recognizes Sonance 1 as the industry's first in-wall and in-ceiling speaker solution.

**CEDIA HALL OF FAME: SA2 SPEAKER**

Recognizes Sound Advance (acquired by Sonance) SA2 as the world's first invisible speaker.

**CEDIA HALL OF FAME: SONAMP 260**

Recognizes Sonance SonAmp 260 as the industry's first distributed audio amplifier.

**CEDIA HALL OF FAME: IPORT IW**

Recognizes iPort IW as the industry's first in-wall dock for iPod.

**CEDIA HALL OF FAME:  
ARCHITECTURAL SERIES SPEAKERS**

**CEDIA HALL OF FAME:  
VISUAL PERFORMANCE  
SERIES SPEAKERS**

**TABLE OF CONTENTS**

3 We Are Dana Innovations

4 Table of Contents

5-6 Technology that Complements, Not Competes

7-16 How Do You Want Your Sound to Look?

17-18 18 Categories

19-22 Visual Performance

23-24 Architectural Series

25-26 Invisible Series

27-28 Amplifiers

29-32 Surround Sound Reference

33-36 Surround Sound Cabinet Subwoofers

37-38 Soundbar

39-40 Outdoor Audio

41-44 Sonance Landscape Series

45-48 Sonarray

49-50 Extreme

51-52 Mariners and Rocks

53-54 Professional Series

55-56 Design Services

57-58 iPort

# TECHNOLOGY THAT COMPLEMENTS, NOT COMPETES

Sonance believes there's more to exceptional speakers than sound alone. They must strike the perfect visual note as well. The shape, the size, the finish and placement; every detail should be considered in the context of the room itself. The right choice not only complements your design, it becomes a part of the design, as deliberate and personal as the flooring below and the lighting above.

30 plus years after we invented the first in-wall speaker, Sonance continues to set the standard for premium loudspeakers. Sonance speakers bridge the gap between aesthetic appeal and acoustic performance by transforming the choice of speaker from an afterthought to an integral element of design.



### **The dilemma of design and technology**

Typical home technology and distributed audio does not consider the design intent or the aesthetic theme of the space. The result can turn a thoughtfully designed space into a clutter of home technology.



### **Preserve the integrity of your design**

Sonance's approach to distributed audio is designed to blend in or even disappear into a space, allowing the original design vision of the space to come through.



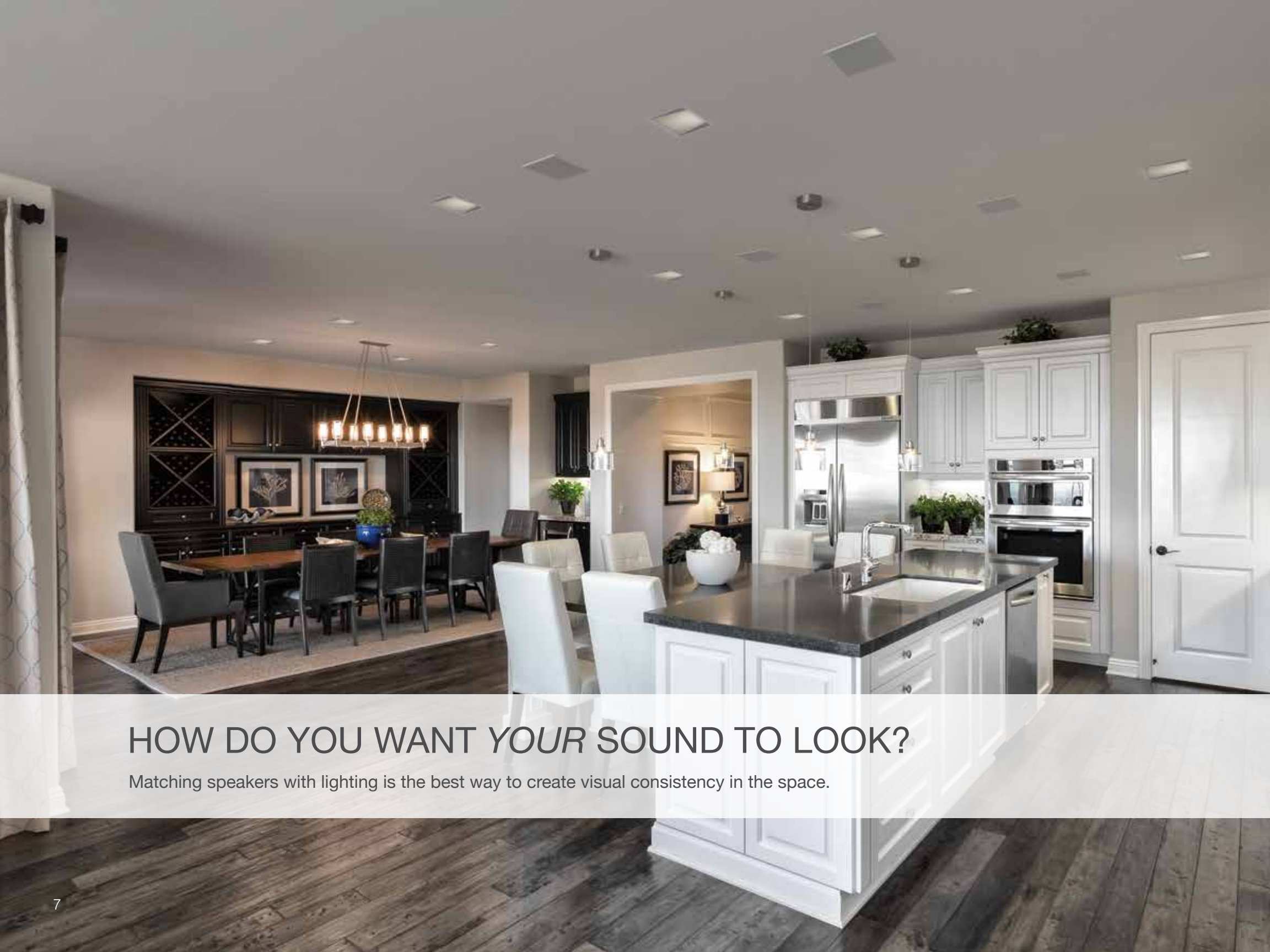

## HOW DO YOU WANT *YOUR* SOUND TO LOOK?

Matching speakers with lighting is the best way to create visual consistency in the space.



### Audio should look like it was designed to be in the space

Start with the lights. Most distributed audio speakers will live in the same space as ceiling lights. The lighting in the ceiling is chosen to fill the space with suitable light and complement the space's design vision. In order to achieve a harmony between lights and speakers, it makes sense for the speakers to match the lighting. You can suit every aesthetic by selecting speakers that are the same shape, size and installation profile as the lighting.

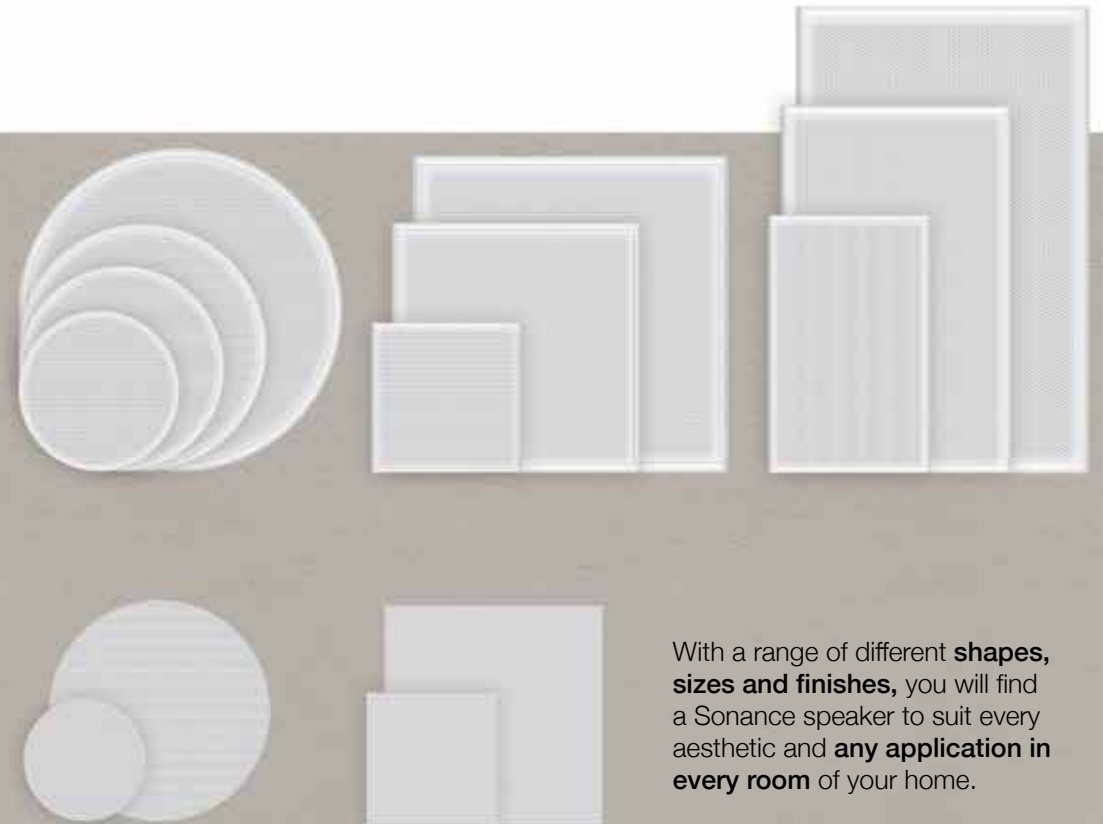
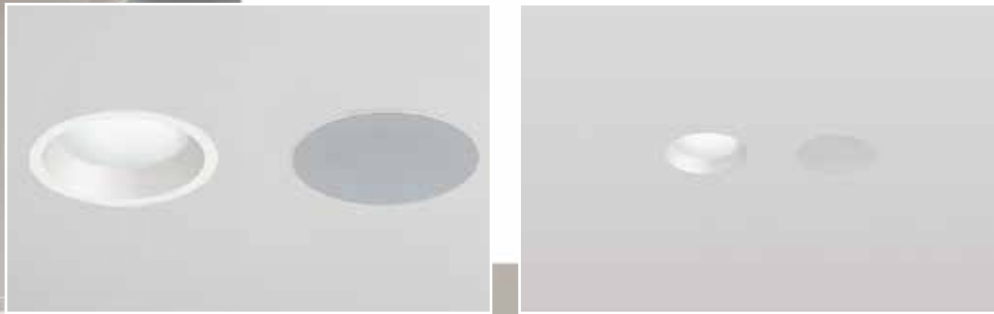

With a range of different **shapes, sizes and finishes**, you will find a Sonance speaker to suit every aesthetic and **any application in every room** of your home.

## EVEN, BALANCED COVERAGE

Just as you have several lights across your ceiling to achieve consistent light levels, the same principle applies to your speakers.



## The Traditional Approach

With only two speakers in a room, you have uneven volume levels; too loud under the speakers and too quiet away from them. Similarly, if there are only two lights in this kitchen, it would exhibit the problems of hot spots with areas that are too bright and areas that are too dim.

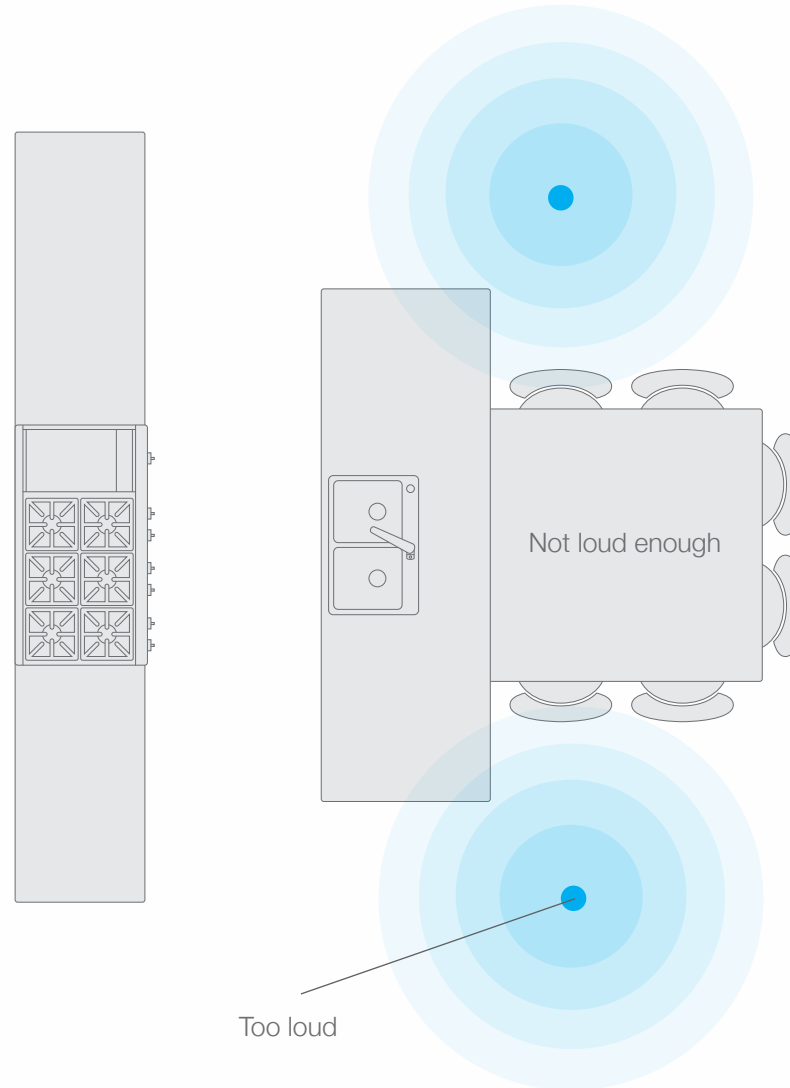

Uneven sound levels will compromise the atmosphere in your room resulting in "hot spots".









## EVEN, BALANCED COVERAGE

Just as you have several lights across your ceiling to achieve consistent light levels, the same principle applies to your speakers.



## Immersive Sound

By using several smaller satellite speakers, hidden subwoofers and DSP amplifiers, you will not only enjoy perfectly even sound coverage throughout the room, it will also be less visually intrusive.

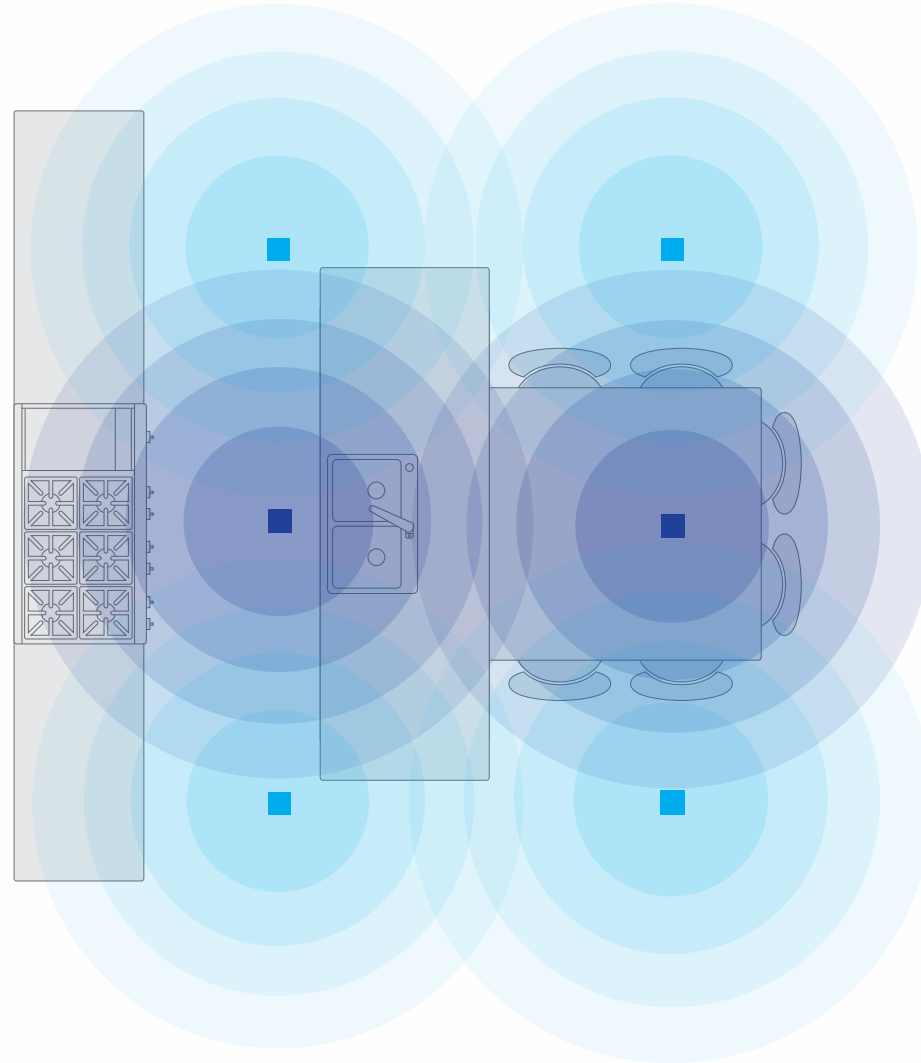

Everyone enjoys the perfect audio level, no matter where they are in the room. The combination of dedicated subwoofers with a small opening consistent with the satellite speakers ensures an immersive sound experience throughout the space.





## A BETTER APPROACH TO HOME AUDIO

Many homes are built with a variety of room sizes, from large, open areas conducive to an **immersive sound experience**, to smaller enclosed areas where immersive sound is not critical. To achieve the desired audio performance in each room, a mix of speaker systems may be utilized; from systems with satellite speakers and hidden subwoofers, to those resembling a more traditional speaker pair solution.

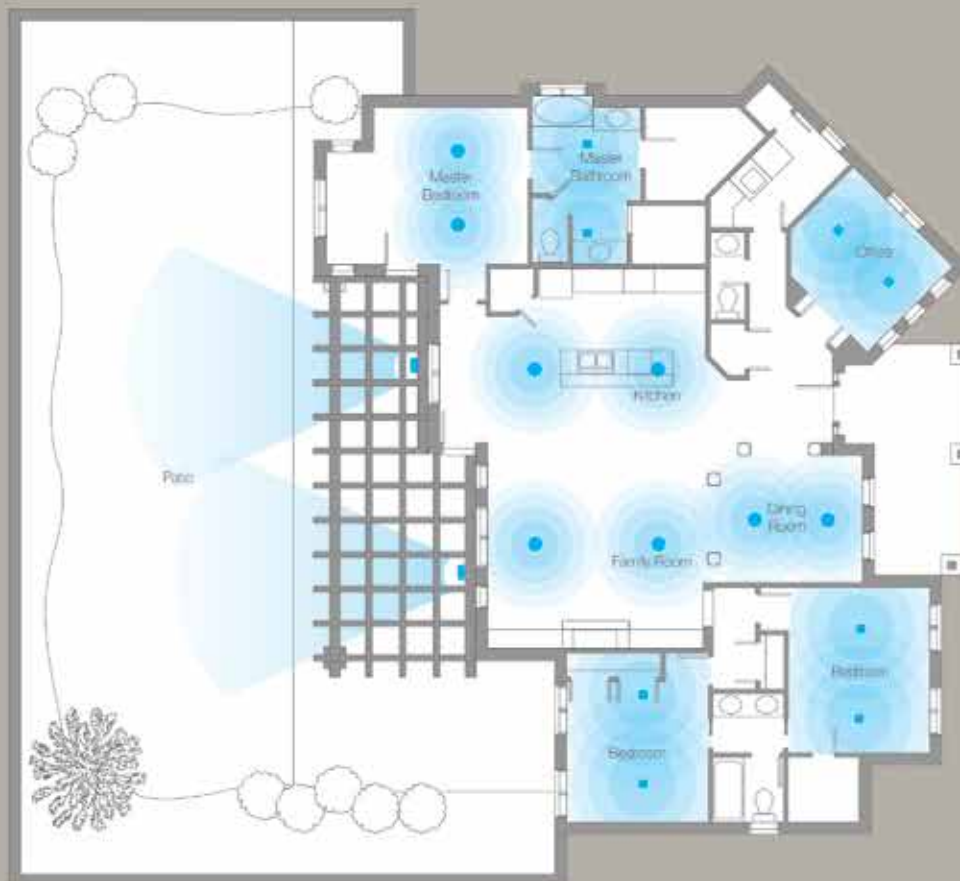

The Traditional Approach

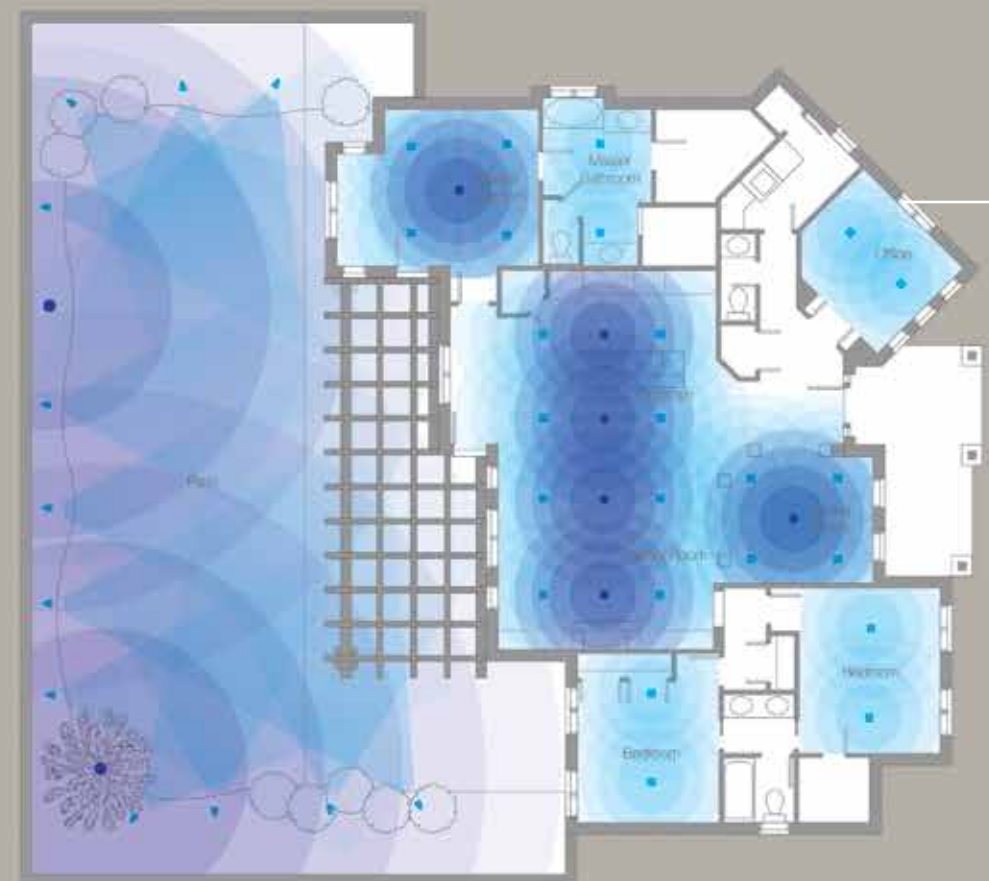

The Optimal Approach





### **The New Definition of Performance**

Performance is not simply defined by a speaker's fidelity and components. Performance in distributed audio is defined by striking the optimal balance between aesthetics, coverage and sonic clarity. Sonance's Speaker Systems & DSP amplifiers are redefining what distributed audio means.

## AMAZING SONIC PERFORMANCE IN ANY ROOM



Every space is acoustically different. DSP amplifiers complete every system by offering digital signal processing to optimize the performance of Sonance Systems and Speakers and to help correct for a room's shape, size and furnishings. This ensures audiophile clarity in every room.



4  
channels

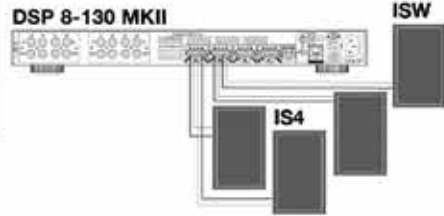

5  
channels

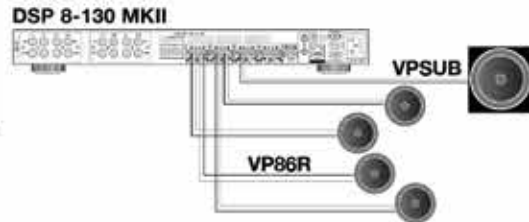

6  
channels

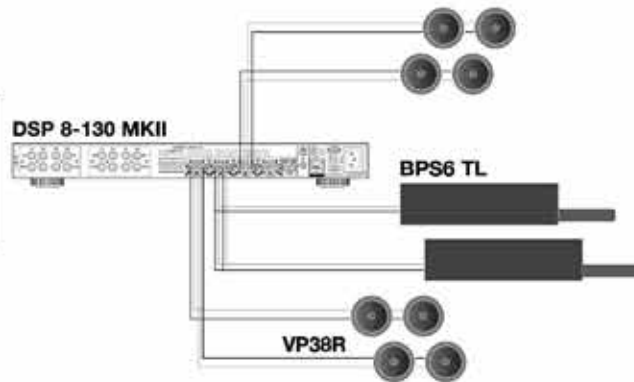

## Adaptable

Whether a space is a new construction, remodel, large or small, DSP amplifiers are powerful and flexible enough to work with various combinations of Sonance speakers and subwoofers.



## Flexible

Sonance Amplifiers offer the flexibility to power subwoofers and speakers on the same channel.



# 18 CATEGORIES

RESIDENTIAL AND COMMERCIAL

## Distributed Audio Systems and Speakers

---

### Visual Performance Series

Systems and Speakers featuring micro trim bezels

### Architectural Series

Systems and Speakers with flush in-ceiling aesthetic

### Invisible Series

Systems and Speakers completely hidden in walls and ceilings

### Digital and DSP Amplifiers

High Resolution DSP amplifiers with presets for all Sonance loudspeakers

## Surround Sound

---

### Reference Loudspeakers and Subwoofers

Purpose built loudspeakers designed to bring out the best in multimedia content featuring micro trim bezels

### Cabinet Subwoofers

Powered cabinet subwoofers that deliver big bass in a small form factor

### Soundbar

A wide range of fixed and adjustable-width Soundbars that fit any flat screen TV from 50" up to 85"







## Outdoor Systems and Speakers

---

### Sonance Landscape Series

Cover any area with even sound and audiophile quality in 8 Ohm or 70V/100V configurations

### SONARRAY

Perfectly balanced sound for areas up to 5000 sq. ft. (464 sq. m.)

### Visual Performance Extreme

Weather resistant in-ceiling and in-wall speakers for patio, spa and marine applications

### Mariners and Rocks

Weather resistant traditional speakers

## Professional

---

### Professional Series 70V/100V Speakers

Complete offering of in-ceiling, pendant and surface mounted loudspeakers



## TRUFIG

---

Brings visual consistency to a wide array of devices and hides technology

## iPort

---

### LuxePort

The next level of iPad® charging and mounting

### LaunchPort

Wall mounted or table top wireless iPad charger and case

### Surface Mount

Wall mounted iPad charger integrable on nearly any surface

### Control Mount

In-wall iPad mounts

### xPRESS

Audio Keypad with direct WiFi control for any Sonos® device





# VISUAL PERFORMANCE

Sonance Visual Performance Series features an award winning low-profile grille that is paintable to blend into the wall or ceiling. With three shapes and four sizes, several performance levels and a range of specialty application speakers, a consistent look can be achieved for any application in every space.

## Direct the Sound Where You Want It



Independently pivoting woofers and tweeters allow you to place your speakers where they look the best, while directing the sound for the best sonic performance.

## Match Your Wall or Ceiling Color

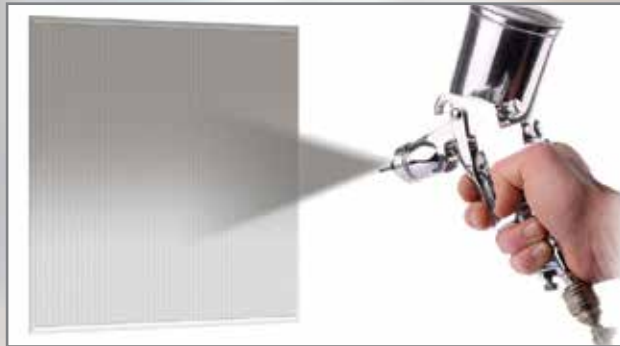

One-piece paintable grilles allow for a single-step painting process, ensuring a high quality result and accurate color matching that allows them to disappear into the surrounding wall or ceiling.



# PERFORMANCE LEVELS

Sonance Visual Performance Series speakers deliver renowned Sonance audio quality in five performance levels.

Constructed from state-of-the-art materials that are extremely rigid and lightweight, Sonance Visual Performance Series Speakers enable music to reproduce accurately and with precise detail.

With multiple performance levels, there is a Sonance speaker for every ear and every budget.



## LEVEL 8

**Woofer:** Carbon Fiber/Rohacell laminated cone with a rubber surround, extended pole piece

**Mid Range (large speakers only):** Carbon Fiber/Rohacell laminated cone with a rubber surround, pivoting

**Tweeter:** Ceramic dome, Ferrofluid cooled, pivoting



## LEVEL 6

**Woofer:** Kevlar/Nomex laminated cone with a rubber surround

**Mid Range (large speakers only):** Kevlar/Nomex laminated cone with a rubber surround, pivoting

**Tweeter:** Powder coated Aluminum dome, Ferrofluid cooled, pivoting



## LEVEL 2

**Woofer:** Textured Polypropylene cone with a rubber surround

**Mid Range (large speakers only):** Textured Polypropylene cone with a rubber surround

**Tweeter:** Cloth dome, Ferrofluid cooled, pivoting



## LEVEL 4

**Woofer:** Textured Polypropylene cone with a rubber surround

**Tweeter:** Powder coated Aluminum dome, Ferrofluid cooled, pivoting



## LEVEL 0

**Woofer:** Polypropylene cone with a rubber surround

**Mid Range (large speakers only):** Polypropylene cone with a rubber surround

**Tweeter:** Cloth dome, Ferrofluid cooled

## Square Adapter

Square grille adapter allows the flexibility to convert a round in-ceiling speaker to a square aesthetic without additional cutting into the surface.



# VISUAL PERFORMANCE Simple to Specify

## SPEAKER NOMENCLATURE

VP 6 6 R

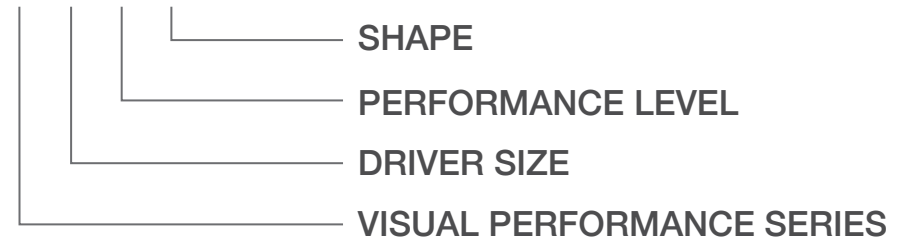

# VISUAL PERFORMANCE

## IN-WALL

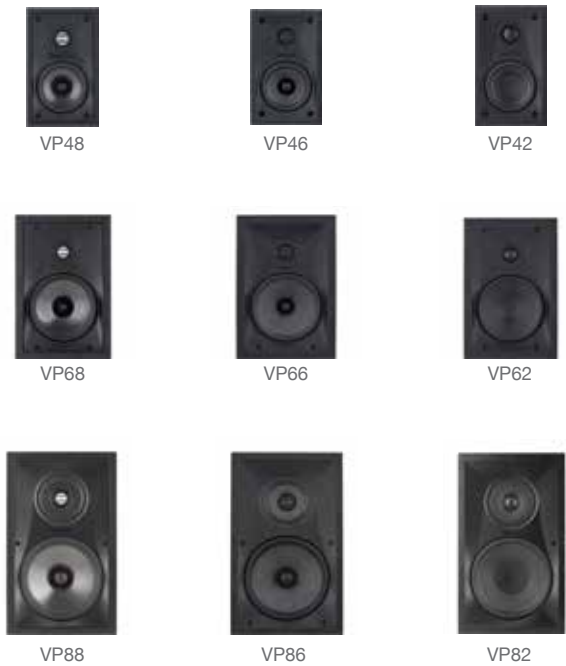

4" Speakers: VP48, VP46, VP42  
Dimensions (WxHxD): 141mm x 225mm x 76mm

6" Speakers: VP68, VP66, VP62  
Dimensions (WxHxD): 213mm x 311mm x 89mm

8" Speakers: VP88, VP86, VP82  
Dimensions (WxHxD): 254mm x 406mm x 98mm

Sold in pairs

## IN-CEILING



3" Speaker: VP38R  
Dimensions (DiaxD): 110mm x 98mm

4" Speakers: VP48R, VP46R, VP42R  
Dimensions (DiaxD): 175mm x 95mm

6" Speakers: VP68R, VP66R, VP64R, VP62R, VP60R  
Dimensions (DiaxD): 248mm x 121mm

8" Speakers: VP88R, VP86R, VP82R, VP80R  
Dimensions (DiaxD): 295mm x 154mm

Sold in pairs (Except VP38R)  
Square adapter optional

## IN-CEILING C SERIES



6" Speakers: C6R, C6R SST  
Dimensions (DiaxD): 229mm x 95mm

Sold in pairs (Except C6R SST)

## SQUARE ADAPTERS



Square Adapter with Grille  
VP3SQ Dimensions (WxH): 125mm x 125mm  
VP4SQ Dimensions (WxH): 178mm x 178mm  
VP6SQ Dimensions (WxH): 251mm x 251mm  
VP8SQ Dimensions (WxH): 298mm x 298mm

Sold in pairs (Except VP3SQ)

## THIN-LINE / ULTRA THIN-LINE



In-Ceiling Round Speakers: VP66R TL, VP62R TL, VP62R SST/SUR TL  
Dimensions (DiaxD): 248mm x 80mm  
In-Ceiling Round Speaker: VP52R UTL  
Dimensions (DiaxD): 248mm x 37mm

In-Wall Rectangle Speaker: VP66 TL  
Dimensions (WxHxD): 141mm x 225mm x 63mm

Sold in pairs (Except VP62R SST/SUR TL)

# VISUAL PERFORMANCE SPECIALTY SPEAKERS

## EXTREME

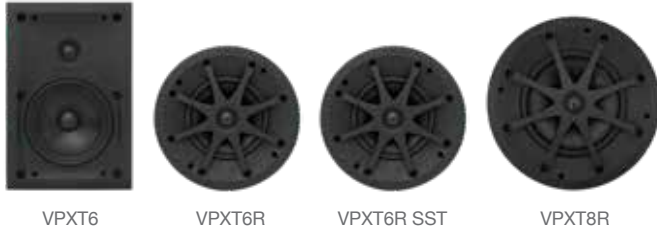

VPXT6 VPXT6R VPXT6R SST VPXT8R

In-Wall Rectangle Speaker: VPXT6  
Dimensions (WxHxD): 213mm x 311mm x 63mm

In-Ceiling Round Speakers: VPXT6R, VPXT6R SST  
Dimensions (DiaxD): 248mm x 89mm

In-Ceiling Round Speaker: VPXT8R  
Dimensions (DiaxD): 295mm x 95mm

Sold in pairs (Except VPXT6R SST)

## EXTREME SQUARE ADAPTERS



VPXT6SQ VPXT8SQ

Square Adapter with Grille  
VPXT6SQ Dimensions (WxH): 125mm x 125mm  
VPXT8SQ Dimensions (WxH): 302mm x 302mm

Sold in pairs

## LCR



VP62 LCR VP66 LCR

In-Wall Speakers: VP62 LCR, VP66 LCR  
Dimensions (WxHxD): 141mm x 225mm x 90mm

Sold as each

## SINGLE STEREO



VP66 SST/SUR VP46R SST/SUR VP62R SST/SUR VP66R SST/SUR VP86R SST/SUR

6" Speaker: VP66 SST/SUR  
Dimensions (HxWxD): 213mm x 311mm x 89mm

4" Speaker: VP46R SST/SUR  
Dimensions (DiaxD): 175mm x 95mm

6" Speakers: VP62R SST/SUR, VP66R SST/SUR  
Dimensions (DiaxD): 248mm x 121mm

8" Speaker: VP86R SST/SUR  
Dimensions (DiaxD): 295mm x 149mm

Sold as each

## PRECONSTRUCTION ACCESSORIES

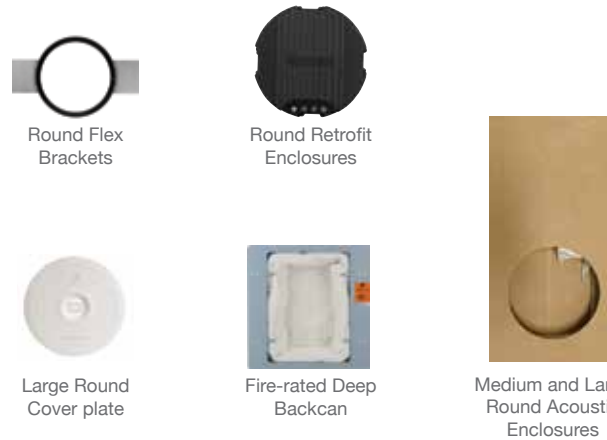

Round Flex Brackets

Round Retrofit Enclosures

Large Round Cover plate

Fire-rated Deep Backcan

Medium and Large Round Acoustic Enclosures

## SUBWOOFERS

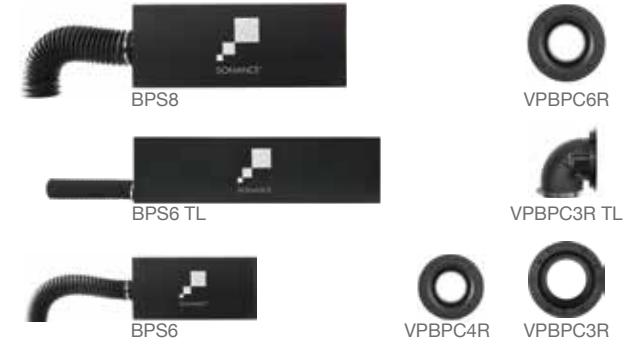

BPS8

VPBPC6R

BPS6 TL

VPBPC3R TL

BPS6

VPBPC4R

VPBPC3R

Subwoofer: BPS8  
Dimensions (HxWxD): 235mm x 313mm x 610mm  
Required Accessory: VPBPC4R or VPBPC6R

Subwoofer: BPS6 TL  
Dimensions (HxWxD): 1000mm x 279mm x 86mm  
Required Accessory: VPBPC3R TL or VPBPC3R

Subwoofer: BPS6  
Dimensions (HxWxD): 200mm x 303mm x 400mm  
Required Accessory: VPBPC3R

Sold as each  
Requires DSP 2-150 MKII or DSP 8-130 MKII amplification.



VPSUB

VP85R W

VP85 W

10" Speaker: VPSUB  
Dimensions (WxHxD): 381mm x 381mm x 98mm

Woofer: VP85R W  
Dimensions (DiaxD): 295mm x 98mm

Woofer: VP85 W  
Dimensions (HxWxD): 406mm x 254mm x 98mm

Sold as each



# ARCHITECTURAL SERIES

Sonance Architectural Series products provide the ultimate blend of high performance and premium aesthetics. The completely flush and bezel-less grilles disappear into the surrounding ceiling surface while the state-of-the-art driver materials and cutting-edge design sets a new standard in audiophile sound quality.

## Custom Installation with a Standardized Process



Precision engineered Mounting Platforms provide flexibility to align with light fixtures or ceiling features and deliver the highest quality result in drywall, plaster, wood and other solid surfaces.



# ARCHITECTURAL SERIES

## DISCREET OPENING



AS38RS



Round Grille



Square Grille

AS38RS Dimensions (DiaxD): 98mm x 97mm

Available in 13mm and 16mm



Discreet Gypsum Mounting Platform Round

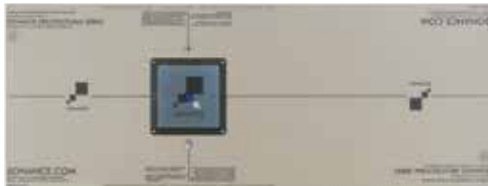

Discreet Gypsum Mounting Platform Square



Discreet Gypsum Mounting Platform SQ & R

16mm Discreet Gypsum Mounting Platform SQ or R  
 13mm Discreet Gypsum Mounting Platform SQ or R  
 Discreet Solid Surface Mounting Platform SQ & R  
 Dimensions (WxHxD): 305mm x 810mm x 37mm

Sold as each

## MEDIUM



AS68RS



Round Grille



Square Grille

AS68RS Dimensions (DiaxD): 203mm x 132mm

Available in 13mm and 16mm



Medium Gypsum Mounting Platform Round

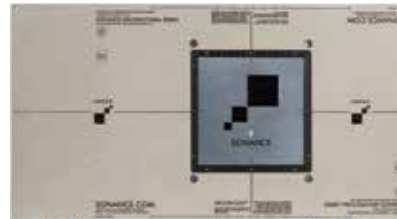

Medium Gypsum Mounting Platform Square



Medium Gypsum Mounting Platform SQ & R

16mm Medium Gypsum Mounting Platform SQ or R  
 13mm Medium Gypsum Mounting Platform SQ or R  
 Medium Solid Surface Mounting Platform SQ & R  
 Dimensions (WxHxD): 416mm x 772mm x 97mm

Sold as each

## BANDPASS SUBWOOFERS

Requires DSP 2-150 MKII or DSP 8-130 MKII amplification.



BPS8



ASBPC6RS



Round Grille



Square Grille

Subwoofer: BPS8

Dimensions (HxWxD): 235mm x 313mm x 610mm

Required Accessories: ASBPC6RS, Medium Mounting Platform



BPS6 TL



ASBPC3RS TL



Round Grille



Square Grille

Subwoofer: BPS6 TL

Dimensions (HxWxD): 1000mm x 279mm x 86mm

Requires Accessories: ASBPC3RS TL, Gypsum Mounting Platform

Available in 13mm and 16mm (in-wall applications & shallow depth construction)



Discreet Gypsum Mounting Platform TL (Round)



Discreet Gypsum Mounting Platform TL (Square)



BPS6



ASBPC3RS



Round Grille



Square Grille

Subwoofer: BPS6

Dimensions (HxWxD): 200mm x 303mm x 400mm

Requires Accessories: ASBPC3RS, Discreet Mounting Platform



# INVISIBLE SERIES

Sonance Invisible Series is the ultimate expression in architectural audio. Installed into the wall or ceiling and then finished over with the surrounding surface, Invisible Series speakers deliver ambient music that emanates throughout the space with no visual footprint.

## Audio That Becomes Part of the Wall



Sonance Invisible Series speakers are finished over with the same material as the adjoining wall or ceiling surface, including regular drywall finishing compound and paint, wallpaper, wood veneer, or even venetian plaster.

## Wide Dispersion

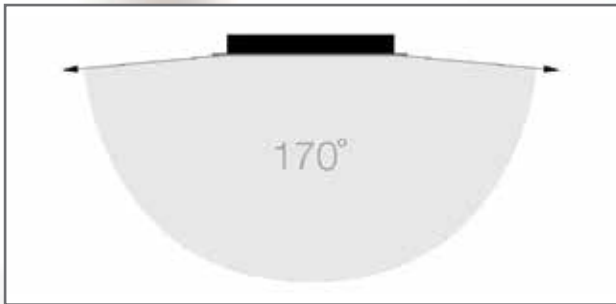

Sonance Invisible Series features a best-in-class 170° of dispersion, which means the sound is spread out wider from the speaker, delivering even volume levels and better sound quality throughout the entire space.



# INVISIBLE SERIES

## Sound Not Sight

Sonance Invisible Series delivers unbelievable sound quality that emanates from the wall or ceiling, without any visible signs of a speaker. The space is filled with breathtaking music that seemingly comes from nowhere.

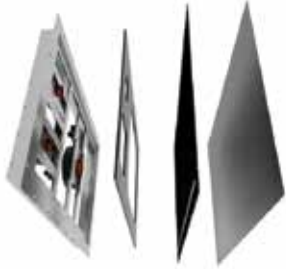

## State-of-the-Art Design and Construction

Sonance Invisible Series speakers feature a high quality extruded aluminum chassis and injection molded polypropylene diaphragm for many years of reliable service and peace of mind.

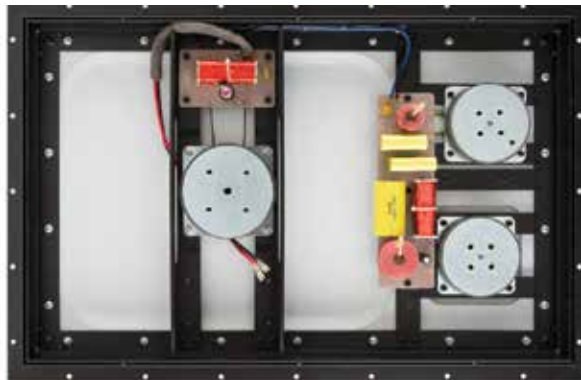

## The World's Best Sounding Invisible Speaker

Sonance Invisible Series speakers reproduce the full range of frequencies, including crystal clear treble, natural midrange and deep smooth bass response. The result is best-in-class sonic performance that sets a new benchmark for the category.

## SPEAKERS



IS2

Small 2-Way Speaker: IS2  
Dimensions (WxHxD): 409mm x 307mm x 51mm

Sold in pairs

## WOOFER



ISW

Woofers: ISW  
Dimensions (WxHxD): 410mm x 613mm x 51mm

Sold as each

## CUSTOM PARTS



IS2 Small Space Saver



IS4, IS4 SST, and ISW Large Space Saver



IS4



IS4 SST



IS4 C

Large 3-Way Speakers: IS4, IS4 SST, IS4 C  
Dimensions (WxHxD): 410mm x 613mm x 94mm

Sold in pairs (Except IS4 SST & IS4 C)



IS2 Small Enclosure



IS4, IS4 SST, ISW Large Enclosure

# AMPLIFIERS

When it comes to reliable distributed audio, nobody has been doing it longer than Sonance. Building from the legacy of the SonAmp 260, recognized as the industry's first distributed audio amplifier, the new range of Sonance Digital and DSP Amplifiers utilizes cutting-edge technology to bring out the absolute best sonic performance from Sonance speakers. The versatile feature-set allows them to be integrated into third-party control systems for simplicity and ease of use.

## Ready for the Future of High-Resolution Audio



At the core of every DSP amplifier is a powerful 24 bit/96K DAC, capable of handling a full 4608 Kbps of audio data. The DSP amplifiers enable listeners to enjoy the full clarity and output of whatever audio passes through, from MP3 to full High Resolution Audio. Sonance DSP amplifiers prepare your audio system for what's next.



# AMPLIFIERS

## SONARC™ V2 Sonance Advanced Room Correction

### Amazing Audio in Any Environment

The new line of DSP amplifiers feature SonARC (Sonance Advanced Room Correction), which offers hundreds of EQ presets designed specifically for Sonance speakers available through simple pull down menus. The presets enable effortless DSP without the need for additional hardware, software and more importantly, time. Additionally, should there be a need for further customization, SonARC provides a 10-band parametric EQ to optimize sonic performance in any space.



### DIGITAL AMPLIFIERS



2-100

ASAP3D SE

12-50

Sold as each

2-100

Output Power per Channel: 100W RMS (8 Ohms)  
156W RMS (4 Ohms), 325W (bridged at 8 Ohms)

ASAP3D SE

Output Power per Channel: 25W RMS (8 Ohms)  
50W RMS (4 Ohms)

12-50

Output Power per Channel: 50W RMS (8 Ohms)  
50W RMS (4 Ohms), 100W (bridged at 8 Ohms)

### DSP AMPLIFIERS WITH SONARC V2



DSP 2-750 MKII

DSP 8-130 MKII

DSP 2-150 MKII

SR 2-125

Sold as each

DSP 2-750 MKII

Output Power per Channel: 500W RMS (8 Ohms)  
750W RMS (4 Ohms), 750W RMS (70V), 2000W (bridged at 8 Ohms)

DSP 8-130 MKII

Output Power per Channel: 130W RMS (8 Ohms)  
145W RMS (4 Ohms), 300W (bridged at 8 Ohms)

DSP 2-150 MKII

Output Power per Channel: 150W RMS (8 Ohms)  
224W RMS (4 Ohms), 473W (bridged at 8 Ohms)

SR 2-125

Output Power per Channel: 125W RMS (8 Ohms)  
200W RMS (4 Ohms)

### Digital Input Module

The Digital Input Module (DIM) is the ultimate performance enhancement to any Sonance distributed audio system. When paired with a SONAMP DSP amplifier, the DIM allows for a direct connection to a digital source ensuring the signal passes through to the sophisticated 24 bit/96kHz capable DAC in the amplifier with the shortest signal path possible and at the highest performance level.

### DIGITAL INPUT MODULE



Digital Input Module

Dimensions (WxHxD): 76mm x 38mm x 87mm

Dimensions with RCAs (WxHxD): 76mm x 38mm x 94mm

Sold as each



# SURROUND SOUND REFERENCE

Sonance takes entertainment to a whole new level with a range of purpose-built products that are specifically designed to bring out the best in television, movies, gaming and concerts. From living rooms to dedicated home theater spaces, the complete range of Sonance Surround Sound products deliver an intense and impactful experience to your home.

## Purpose-Built for the Ultimate Sound



Created for AV Designers building systems that require the best surround sound available with a look that fits the space aesthetically, Sonance Reference provides truly incredible sound. Engineered for an amazing cinema experience in any room, Sonance Reference has options for in-wall, in-ceiling, cabinet speakers and in-wall subwoofers.



# REFERENCE IN-WALL, IN-CEILING AND LCR CABINET SPEAKERS



## Material Matters

Sonance Reference utilizes state of the art driver materials to deliver tight punchy bass and crystal-clear dialog, the key to achieving surround sound that is both natural and exhilarating.



## Integrated Cabinets for Amazing Sound

Sonance Reference in-wall and in-ceiling speakers feature an integrated cabinet design that delivers optimum sonic performance, while reducing sound transfer into adjoining rooms.



## Mix and Match

No two spaces are the same, which is why Reference Series speakers are designed to be mixed and matched to suit any room layout. The consistent drivers and crossover design allows for in-wall, in-ceiling or cabinet speakers to be combined without compromising the sonic performance of the system.

## IN-WALL



R2

R2SUR

In-Wall Speakers: R2, R2SUR

Dimensions (WxHxD): 225mm x 886mm x 98mm

Sold as each



R1

R1SUR

In-Wall Speakers: R1, R1SUR

Dimensions (WxHxD): 225mm x 552mm x 98mm

Sold as each

## IN-CEILING



R1C

R1SURC

In-Ceiling Speakers: R1C, R1CSUR

Dimensions (WxHxD): 350mm x 350mm x 192mm

Sold as each

## REFERENCE LCR CABINET



R1CAB

LCR Cabinet: R1CAB

Dimensions (WxHxD): 191mm x 559mm x 179mm

Sold as each

# SURROUND SOUND REFERENCE

Reference In-Wall subwoofers deliver the big bass of a large cabinet subwoofer without sacrificing floor space, while the micro trim grille provides a clean and discreet aesthetic that can be painted to match the surrounding wall color.

## Constructed for Superior Performance



Sonance Reference in-wall subwoofers utilize large neodymium magnets, dual inverted spiders and a rigid laminated carbon fiber cone to achieve deep, impactful bass from a shallow design that can be installed into a standard 2x4 wall cavity.





# REFERENCE IN-WALL SUBWOOFERS



## In-Wall Subwoofers

Sonance Reference in-wall subwoofers feature a specialized cabinet design that is installed leaving only the low-profile grille visible in the room. Installed prior to drywall, this unique in-wall form factor delivers the output of a large cabinet subwoofer without sacrificing floor space or compromising the aesthetics of the room.

## IN-WALL SUBWOOFERS



10" Subwoofer: R10SUB  
Dimensions (WxHxD): 265mm x 265mm x 80mm

12" Subwoofer: R12SUB  
Dimensions (WxHxD): 314mm x 314mm x 80mm

10" Enclosure: R10SUB ENC  
Dimensions (WxHxD): 362mm x 1200mm x 87mm

12" Enclosure: R12SUB ENC  
Dimensions (WxHxD): 362mm x 1800mm x 87mm

Sold as each

## IN-WALL SYSTEMS



R10SUB ENC System  
Includes 2 Subwoofers, 2 Enclosures, 1 DSP 2-150

R12SUB ENC System  
Includes 2 Subwoofers, 2 Enclosures, 1 DSP 2-750

Sold as systems

# SURROUND SOUND CABINET SUBWOOFERS

Sonance Cabinet Subwoofers include built-in wireless technology and app based room correction, optimizing placement of the subwoofer anywhere in the room. The integrated amplifier with a completely sealed amp plate provides low frequency impact for even the biggest room, while the rear or bottom mounted controls provide quick access to adjust the subwoofer as needed.

## SONARC™ V2

Sonance Advanced Room Correction

### One App, Two Simple Set-up Options

- The SonARC app allows you to instantly configure the Impact Subwoofer for great playback with key adjustment at your fingertips.
- Let Sonance adjust the Impact Subwoofer to the room with SonARC customization within the app.



### Impact Subwoofers

Sonance Impact Subwoofers are built to deliver powerful, accurate, low-distortion bass to any room. Featuring glass fiber woofer cones, a sealed amp plate and front facing port design; Impact Subwoofers are the perfect choice for watching TV or movies, playing video games and listening to music.



# IMPACT CABINET SUBWOOFERS



## Elegant Piano-Black Finish

Impact Subwoofers feature a high gloss piano-black finish and black cloth speaker grille to deliver an elegant and minimalistic aesthetic. The cabinet dimensions have been kept to a minimum to reduce the visual impact in the room.



Sonance Impact Subwoofers are available in three sizes and power levels to deliver the perfect amount of bass for any room size and every application. The different dimension options also provide the flexibility to select the correct size to fit into cabinetry or hide behind furniture.

## IMPACT SUBWOOFERS



i8



i10



i12

### 8" Subwoofer: i8

Dimensions (WxHxD): 305mm x 356mm x 305mm

### 10" Subwoofer: i10

Dimensions (WxHxD): 356mm x 406mm x 356mm

### 12" Subwoofer: i12

Dimensions (WxHxD): 406mm x 457mm x 406mm

Sold as each

## WIRELESS TRANSMITTER



### Wireless Transmitter

Dimensions (WxHxD): 30mm x 79mm x 64mm

Sold as each



# SURROUND SOUND CABINET SUBWOOFERS

The Sonance D8 Subwoofer delivers remarkably powerful bass from an ultra-compact cabinet featuring two powerful opposing 203mm square drivers. Paired with the optional wireless transmitter and SonARC DSP technology, the D8 placement becomes completely flexible allowing it to live virtually anywhere in the room.

## Dual Driver Technology



## SONARC™ V2 Sonance Advanced Room Correction

### One App, Two Simple Set-up Options

- The SonARC app allows you to instantly configure the Impact Subwoofer for great playback with key adjustment at your fingertips.
- Let Sonance adjust the Impact Subwoofer to the room with SonARC customization within the app.



# D8 CABINET SUBWOOFERS

## D8 SUBWOOFER



8" Subwoofer: D8  
Dimensions (WxHxD): 191mm x 191mm x 229mm

Sold as each  
Available in black and white



The Sonance D8 subwoofer features two powerful vibration-canceling 203mm square drivers, wireless connectivity and our SonARC for subwoofers DSP technology, all within a sleek ultra-compact cabinet.

## WIRELESS TRANSMITTER



Wireless Transmitter  
Dimensions (WxHxD): 30mm x 79mm x 64mm

Sold as each



# SOUNDBAR

Sonance Soundbars offer a wide range of solutions that fit any flat screen TV from 50" up to 85". Our fixed width soundbars provide a clean aesthetic while our adjustable width soundbars offer onsite adjustability, giving you the ability to perfectly match the width of any television. The minimalistic black perforated metal grille provides a seamless aesthetic that complements modern television designs, while the true 3-way speaker configuration and state-of-the-art driver materials deliver best-in-class sonic performance, with clarity, wide sound stage and extremely natural sound.

## Match the Width of Your TV, Perfectly



Sonance Soundbars features sliding end grilles that are adjusted without the use of any tools. Simply loosen the thumbscrew on the back and slide the grille out to perfectly match the width of the display. It couldn't be easier.





# SOUNDBAR

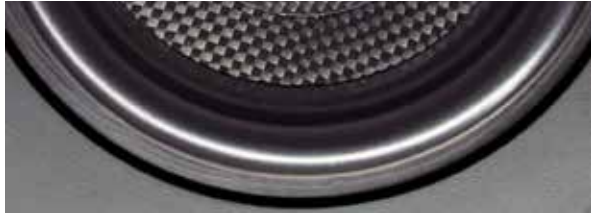

## Putting the Sound in Soundbar

Sonance Soundbars utilize the same cutting edge technology and state-of-the-art materials developed for its award winning Visual Performance Series. This has resulted in best-in-class performance and what is widely considered to be the world's best sounding soundbars.



## World's Only True 3-Way Design

Each of the three speaker chambers feature a coaxial 25mm powder-coated aluminum tweeter, a 102mm laminated Kevlar and Nomex midrange, paired with dual 114mm laminated Kevlar and Nomex woofers. This combination delivers sound which is both natural and precise.



## Extruded Aluminum and Perforated Steel

Sonance Soundbars are constructed from the highest quality materials including aircraft grade extruded aluminum and powder-coated perforated steel. This provides extraordinary durability, preventing deforming and discoloring over time.

# SOUNDBAR



SB46-55



SB46-65

Soundbar: SB46-55

Dimensions (Width): 1227mm (Display Size): Diagonal 1397mm

Sold as each

Soundbar: SB46-65

Dimensions (Width): 1445mm (Display Size): Diagonal 1651mm

Sold as each



SB46-75



SB46-85

Soundbar: SB46-75

Dimensions (Width): 1667mm (Display Size): Diagonal 1905mm

Sold as each

Soundbar: SB46-85

Dimensions (Width): 1911mm (Display Size): Diagonal 2159mm

Sold as each

# ADJUSTABLE-WIDTH SOUNDBAR



SB46M Soundbar

Soundbar: SB46M

Dimensions (Adj. WxHxD): 1114mm - 1514mm x 134mm x 65mm

Sold as each



SB46L Soundbar

Soundbar: SB46L

Dimensions (Adj. WxHxD): 1562mm - 1964mm x 134mm x 65mm

Sold as each

## SUGGESTED SPEAKER PAIRING



VP46R SST/SUR

4" Speaker

Dimensions (DiaxD): 175mm x 95mm

Sold as each

## SUGGESTED SUBWOOFER PAIRING



i10

10" Subwoofer

Dimensions (WxHxD): 356mm x 406mm x 356mm

Sold as each



# THE NEW LANDSCAPE OF OUTDOOR AUDIO

Sonance continues its award-winning audio philosophy outdoors, with a range of all-weather products that are designed to deliver best-in-class performance and best looking aesthetics in every exterior environment. From courtyards and patios to entire residential estates and resort gardens, Sonance is the undisputed leader in high fidelity sound for the great outdoors.





## TRADITIONAL SPEAKER PLACEMENT

In typical outdoor audio installations a pair of speakers are placed in one location and usually on the same plane. The result can produce various undesirable effects.

### Uneven Volume

Speaker placement in one location creates very loud areas near those speakers and little to no sound further away. This can impact furniture arrangements and natural gathering areas.

### Unbalanced Coverage

It is easy to move in and out of the left and right channels and miss discrete information in the audio.

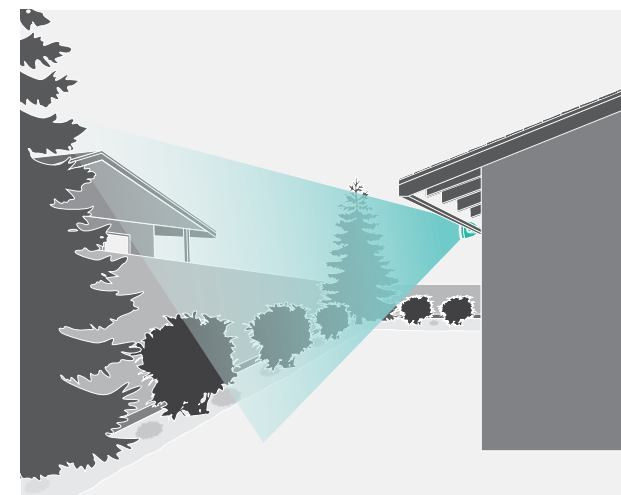
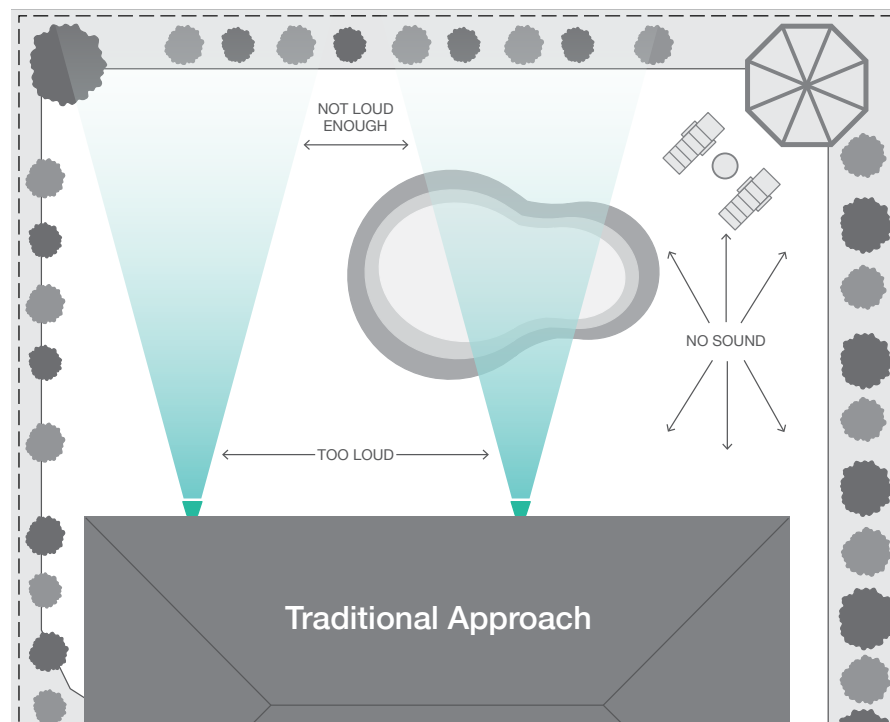

### Unwanted Noise

Audio can spill over to neighboring properties creating unwanted disturbances.

## A BETTER APPROACH

Creating a system composed of satellite speakers, subwoofers, amplifiers and DSP technology helps envelop a space fully in clear and balanced audio.

### Even Volume

This approach is similar to a well layered lighting design that has no hot spots or dark spots, but rather provides smooth even coverage throughout the area.

### Immersive Sound

With satellite speakers and buried subwoofers strategically arranged around the perimeter of the property, audio is able to cover the area from all angles and comfortably immerse the audience.

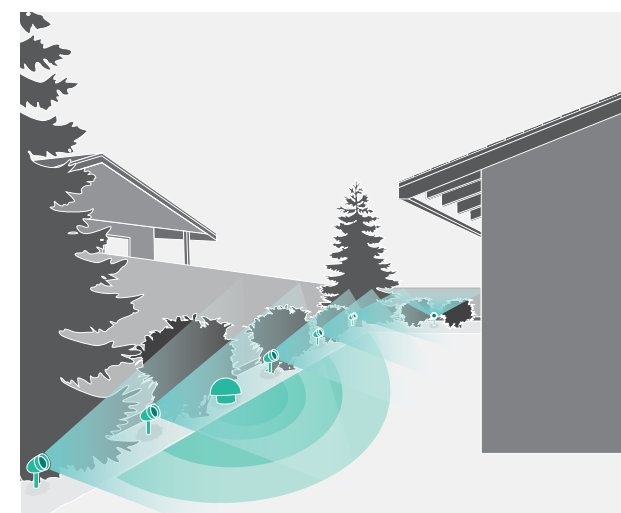

### No Disturbances

By positioning the system's speakers and subwoofers toward the listening area, no sound is projected out to the neighbors.



# SONANCE LANDSCAPE SERIES

Sonance Landscape Series is a fully scalable and bespoke premium outdoor audio system that delivers perfectly even coverage and unbelievable sound quality throughout any size space. Capable of impeccable fidelity at any volume and powerful output while hidden among landscape elements, SLS continues the Sonance standard of performance and design working in harmony to deliver an exceptional experience in any outdoor environment.

## Fully Scalable and Totally Expandable



Sonance Landscape Series speakers and subwoofers feature the Sonance Laminated Core Transformer with an adjustable tap for custom system configuration in any application. Flexibility for 8 Ohm or 70V/100V settings, SLS speakers and subwoofers can be easily tuned for large open spaces with many speakers or intimate areas with few speakers, optimizing each piece of the system for a completely tailored experience.



# SONANCE LANDSCAPE SERIES



## Satellite Speakers

Sonance Landscape Series satellite speakers are designed borrowing proven successful performance features of other Sonance products. With new larger Klippel distortion treated drivers as seen in VP Extreme and the same Sonance Laminated Core Transformer as Sonance Professional Series products, SLS satellites provide smooth, effortless bass and clear and natural treble.



## Smooth and Powerful Bass Response

Sonance Landscape Series subwoofers are available in 305mm and 381mm in-ground or 305mm hardscape solutions. With a laminar flow port supporting the in-ground subs and the Sonance Laminated Core Transformer featured in all three subs, Sonance Landscape Series subwoofers offer the perfect punch for outdoor environments, filling the space with depth and detail.



## SATELLITES



LS6T SAT



LS4T SAT

LS6T SAT Speaker  
Dimensions (Dia): 165mm

LS4T SAT Speaker  
Dimensions (Dia): 114mm

Sold as each

## SUBWOOFERS



LS15T SUB



LS12T SUB



HS12T SUB

Sunwoofer: LS15T SUB  
Overall Dimensions (WxH): 540mm x 853mm

Subwoofer: LS12T SUB  
Overall Dimensions (WxH): 431mm x 740mm

Subwoofer: HS12T SUB  
Dimensions (WxHxD): 410mm x 410mm x 410mm

Sold as each



# SONANCE LANDSCAPE SERIES

Sonance Landscape Series has the output and sound performance required for large scale commercial applications or residential spaces, large or small.

Premium Durability and Performance





# SONANCE LANDSCAPE SERIES

## Weather the Elements



The Sonance Landscape Series speakers and subwoofers are designed to operate under the most extreme weather conditions, from -29 to 88 C.

Triple sealed enclosures, waterproof connectors and marine grade components ensure SLS will stand up to the harshest elements including surf, sun, sand and snow.

## Flexible Installation



Sonance Landscape Series speakers feature versatile mounting hardware options, allowing them to be positioned strategically to create the optimal sound experience

## SATELLITES

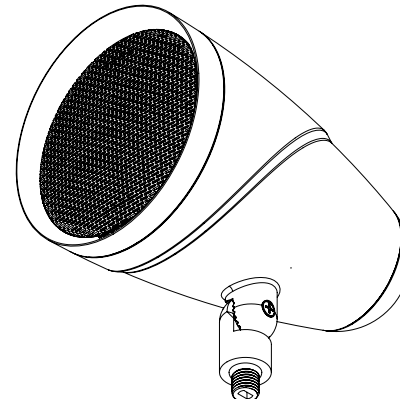

LS6T SAT

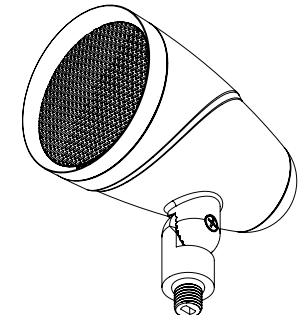

LS4T SAT

## SUBWOOFERS

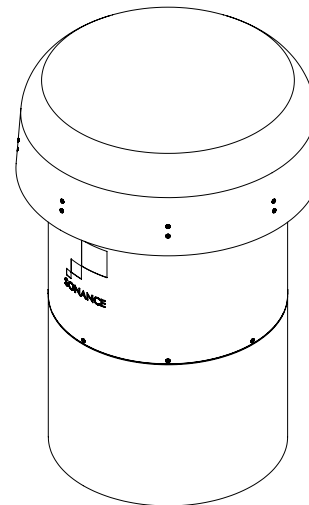

LS15T SUB

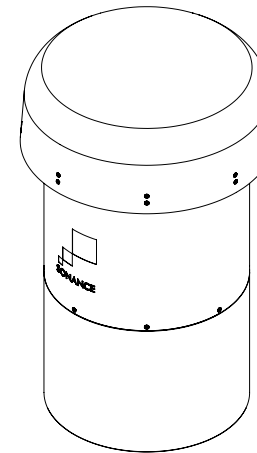

LS12T SUB

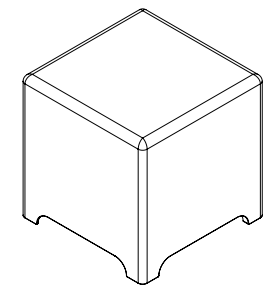

HS12T SUB



# SONARRAY

SONARRAY SR1 is a satellite and subwoofer speaker system that raises the bar on affordable outdoor audio. The SR1 system delivers amazing sound quality and perfectly even volume levels throughout the space. SONARRAY brings a whole new level of atmosphere and ambiance to backyard entertaining.

## Perfect Quality, Perfect Coverage



Sonarray is a complete landscape system designed to cover areas of 185 to 232 square meters of listening space. Beginning with 8 satellite speakers, one in-ground subwoofer and a single amplifier, the system can expand to an additional 8 speakers and a second subwoofer for a total of 16 speakers and 2 subwoofers on a single amplifier.



# SONARRAY

## Satellite Speakers

SONARRAY SR1 includes eight satellite speakers that feature full-range drivers to deliver crystal clear sound. By positioning the satellites around the perimeter of the backyard facing inwards, the space is enveloped in high quality sound at the perfect volume, without loud zones or dead spots.

## Subwoofer

The SONARRAY SR1 features an 203mm dual voice coil subwoofer, which delivers incredibly smooth bass. The SR1's subwoofer radiates sound throughout the same area as the eight satellite speakers, pairing even bass with breathtaking fidelity and clarity.

## Bring It All Together

The last piece of SONARRAY SR1 is the SR 2-125 amplifier. With presets designed for SONARRAY SR1, and tested for any environment, the SR 2-125 perfectly tunes and balances the SONARRAY SR1 System. A single SR 2-125 amplifier will support an SR1 System of 8 speakers and 1 subwoofer or can support an expanded system for greater area coverage. Anywhere from 8 speakers and 1 subwoofer up to 16 speakers and 2 subwoofers can be configured on a single SR 2-125 amplifier.



## SONARRAY SR1 SYSTEM



SONARRAY SR1 System with SR 2-125 Amplifier

SONARRAY SR1 System without Amplifier

Sold as systems

SONARRAY SR1 can be expanded for up to 16 speakers and 2 subwoofers on a single amplifier.

## SR 2-125 AMPLIFIER



Amplifier: SR 2-125

Dimensions with feet (WxHxD): 219mm x 54mm x 427mm

Sold as each

## SONARRAY SR1 SAT 4-PACK



SR1 SAT 4-PACK

Overall Dimensions (LxDia): 165mm x 105mm

Sold as a 4-pack

## SONARRAY SR1 SUB



Subwoofer: SR1SUB

Overall Dimensions (LxDia): 559mm x 381mm

Sold as each



# SONARRAY

Great in backyards and patios, the SONARRAY system of satellite speakers, subwoofer, and SR 2-125 Amplifier creates crystal clear audio emanating from everywhere, and raises the bar on affordable outdoor audio.

## Product Features



The satellite and subwoofer are finished in a neutral earth tone, allowing them to camouflage within the plants and foliage of your outdoor area.



# SONARRAY CONFIGURATIONS

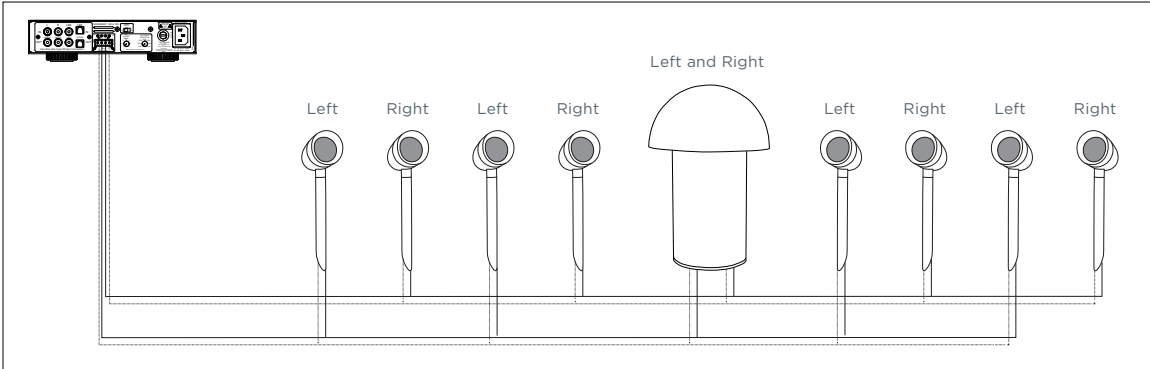

SONARRAY 8:1 CONFIGURATION

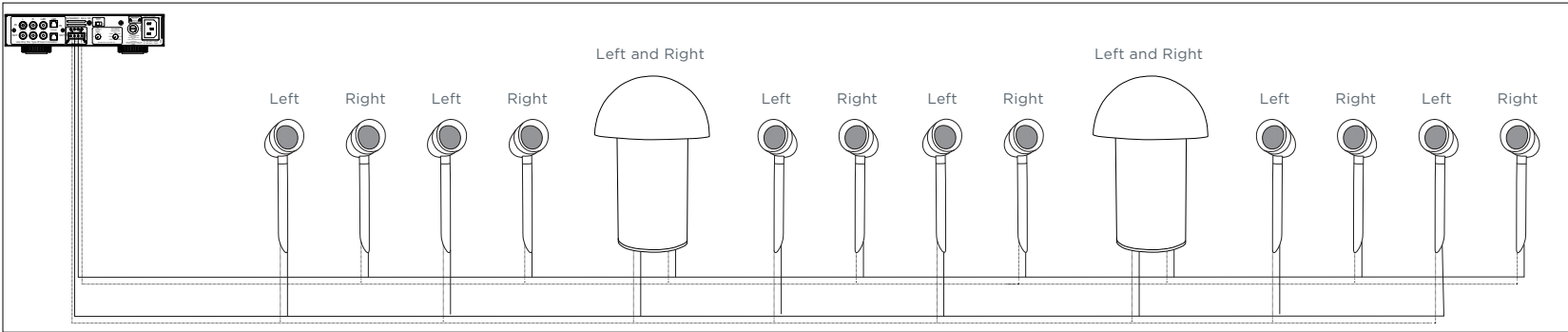

SONARRAY 12:2 CONFIGURATION

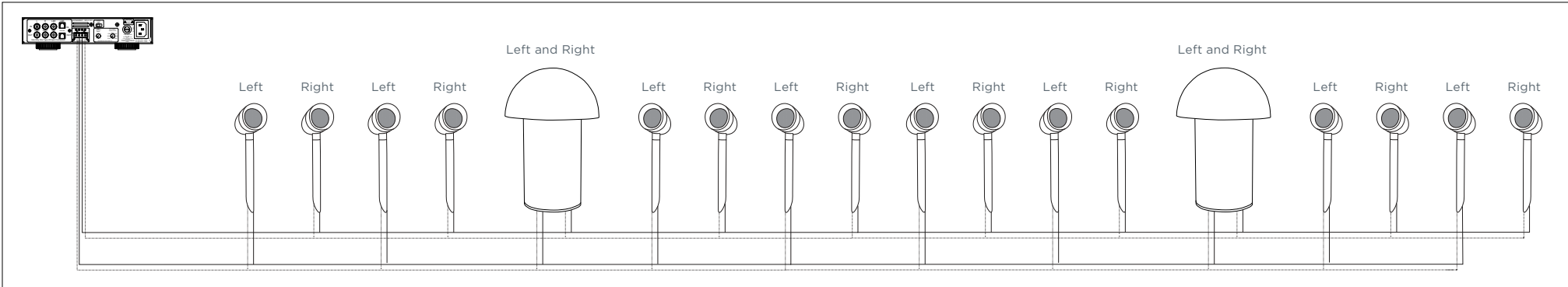

SONARRAY 16:2 CONFIGURATION



# EXTREME

Visual Performance Extreme carries the design success of Sonance Visual Performance speakers delivered in a highly enduring construction for extreme elements making them perfect for marine environments, patios and spas.

## VPXT6SQ & VPXT8SQ



VP Extreme square grille adapters and grilles seamlessly transform any Extreme round speaker into a square aesthetic without the need for additional cutting. Also featuring Sonance XPC technology, square grilles will remain intact when presented with intense wind or water.





# VISUAL PERFORMANCE EXTREME

## Extreme

With extreme circumstances in mind, Sonance developed Extreme Post Capture grille retention technology (XPC) to securely grip each Extreme grille to its speaker. This protects the grilles from harsh encounters with wind and high pressure washing.



## SQUARE ADAPTERS

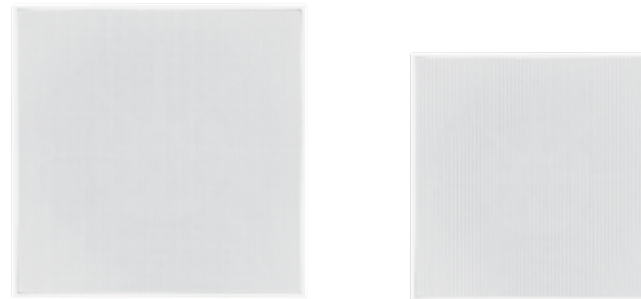

Grille: VPXT8SQ  
Dimensions (WxH): 279mm x 279mm

Grille: VPXT6SQ  
Dimensions (WxH): 251mm x 251mm

Sold in pairs

## RECTANGLE SPEAKER



VPXT6

Speaker: VPXT6  
Dimensions (WxHxD): 213mm x 311mm x 64mm

Sold in pairs

## ROUND SPEAKERS



VPXT8R



VPXT6R



VPXT6R SST

Speaker: VPXT8R  
Dimensions (DiaxD): 295mm x 95mm

Speakers: VPXT6R, VPXT6R SST  
Dimensions (DiaxD): 248mm x 89mm

Sold in pairs (Except for VPXT6R SST)

# MARINERS AND ROCKS

Sonance has a range of high performance outdoor speakers for any traditional installation. Rock speakers and subwoofers in natural colors and textures are designed to hide in garden beds. Mariner speakers are perfect for courtyards and patios. Extreme in-wall and in-ceiling speakers are great for outdoor rooms, under eaves and demanding marine applications.

## Sonance Outdoor Speakers



Sonance Mariner outdoor speakers feature the same award-winning technology utilized in today's Visual Performance speakers. All Mariner speakers sport a sleek modern look, available in black or white color options. With seven different models to choose from, there is a speaker to suit nearly any outdoor or marine applications and the most critical ear.





# MARINERS AND ROCKS



## Mariners

Sonance Mariner speakers feature an innovative front-mounted terminal connection that not only makes wiring easier, it safeguards the speaker terminals against moisture and the elements. Mariner speakers feature an exclusive Fastmount® bracket system that enables simple push and lock to fasten each speaker into place—no threaded knobs or extra hardware necessary. Once mounted, the speaker can be easily pivoted to direct the sound where you want it, and they will stay where you position them and not droop or slip over time. Finished with a perfect fit trim-less grille engineered to remain securely in place, Mariner speakers will contribute a sleek and clean look to any outdoor space.



## Rocks

Sonance rock speakers utilize a durable weather-resistant construction that is built to withstand the harshest outdoor environments. Featuring waterproof drivers, the Sonance RK63 and RK83 deliver clean articulate sound while standing up to the elements. For those wanting even more impressive sound outdoors, the optional RK10W subwoofer features the same durable construction with a 254mm polypropylene cone woofer for added bass response.

## MARINERS



MARINER 54



MARINER 54 SST



MARINER 56



MARINER 64



MARINER 64 SST



MARINER 66



MARINER 86

Small Speakers: Mariner 54, Mariner 54 SST, Mariner 56  
Dimensions (WxHxD): 162mm x 256mm x 144mm

Medium Speakers: Mariner 64, Mariner 64 SST, Mariner 66  
Dimensions (WxHxD): 191mm x 308mm x 174mm

Large Speaker: Mariner 86  
Dimensions (WxHxD): 229mm x 356mm x 218mm

Sold in pairs (Except for Mariner 54 SST / Mariner 64 SST)  
Available in black and white

## ROCKS



RK63



RK83

Small Rock Speaker: RK63  
Dimensions (WxHxD): 349mm x 279mm x 279mm

Large Rock Speaker: RK83  
Dimensions (WxHxD): 438mm x 318mm x 356mm

Sold in pairs  
Available in brown and granite

## ROCK SUBWOOFER



RK10W Woofer

Rock Woofer: RK10W  
Dimensions (WxHxD): 492mm x 429mm x 365mm

Sold as each  
Available in brown and granite



# PROFESSIONAL SERIES

The New Standard in Commercial Audio.



## Performance

- Class-leading sensitivity & sonic performance
- Exceptional off-axis response
- Heavy duty voice coil for longevity and reliability
- Full-fidelity transformer for uncompromisable tonality
- Consistent voicing across product range



# PROFESSIONAL SERIES

## IN-CEILING

- UL 1480 & UL 2043 Certified
- 2-way pivoting tweeter
- Finger-adjustable tap switch
- Integrated backcan
- One-piece magnetic grille (paintable)
- Optional black grille
- Optional square adapter (black or white grille)



## PENDANT

- UL 1480 & UL 2239 Certified
- 2-way pivoting tweeter
- One-piece magnetic grille
- Black or white (paintable) options
- Front-mounted tap switch
- Hanger & connector cover
- Ships with gripple kit for mounting



## SURFACE MOUNT

- UL 1480, IPX4, MIL SPEC810, & UV IEC 529 Certified
- Powder coated aluminum grille
- Black or white (paintable) options
- Front-mounted tap switch
- Front-mounted connector with cover
- FastMount® bracket system



## IN-CEILING



PS-C43RT PS-C63RT PS-C83RT PS-C83RWT PS-C43RTLTP PS-C63RTLTP

### In-Ceiling Speakers

PS-C43RT Dimensions (DiaxD): 160mm x 178mm  
 PS-C63RT Dimensions (DiaxD): 232mm x 225mm  
 PS-C83RT Dimensions (DiaxD): 281mm x 250mm  
 PS-C83RWT Dimensions (DiaxD): 281mm x 250mm  
 PS-C43RTLTP Dimensions (DiaxD): 232mm x 87mm  
 PS-C63RTLTP Dimensions (DiaxD): 281mm x 111mm

Sold in pairs (Except PS-C83RWT)  
 Available in black or white grille

## SURFACE MOUNT



PS-S43T PS-S53T PS-S63T PS-S83T PS-S83WT

### Pendant Speakers

PS-S43T Dimensions (WxHxD): 235mm x 139mm x 122mm  
 PS-S53T Dimensions (WxHxD): 256mm x 162mm x 144mm  
 PS-S63T Dimensions (WxHxD): 315mm x 191mm x 174mm  
 PS-S83T Dimensions (WxHxD): 356mm x 229mm x 218mm  
 PS-S83WT Dimensions (WxHxD): 356mm x 229mm x 218mm

Sold in pairs (Except PS-S83WT)  
 Available in black and white

## PENDANT



PS-P43T PS-P63T PS-P83T PS-P83WT

### Pendant Speakers

PS-P43T Dimensions (DiaxH): 160mm x 279mm  
 PS-P63T Dimensions (DiaxH): 232mm x 396mm  
 PS-P83T Dimensions (DiaxH): 281mm x 500mm  
 PS-P83WT Dimensions (DiaxH): 281mm x 500mm

Sold in pairs (Except PS-P83WT)  
 Available in black and white

## INVISIBLE



IS4 C

### Speaker: IS4 C

Dimensions (WxHxD): 356mm x 229mm x 218mm

Sold as each

# DESIGN SERVICES

## **Customized Layouts**

Sonance offers design services to support our customers. Our role is to help you maximize the value and performance of your Sonance Speaker System. Service Representatives are available whenever you need them to make sure your system performs as expected.

Contact Design Services at [www.designservices@danainnovations.com](http://www.designservices@danainnovations.com)



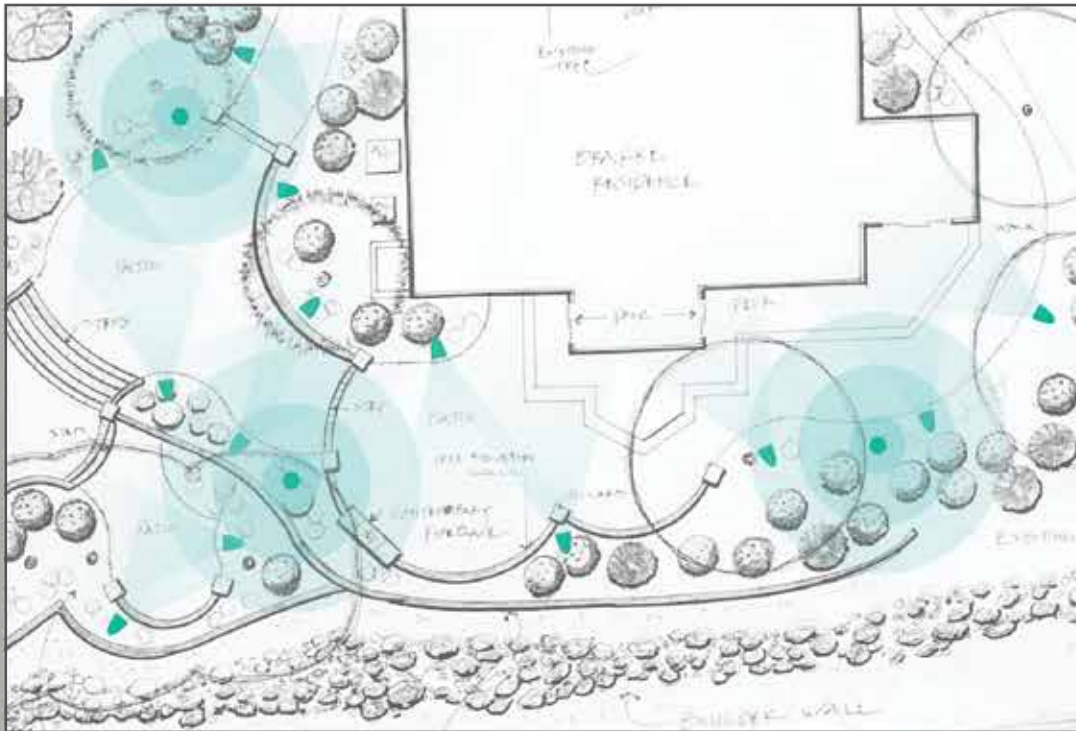

### Outdoor Design

Landscape Series Design Service provides a custom layout program for Landscape Series speaker systems. This service will convert any project's Landscape Plan into a discreet layout for each zone showing the best possible placement for all of the satellites and subwoofers.

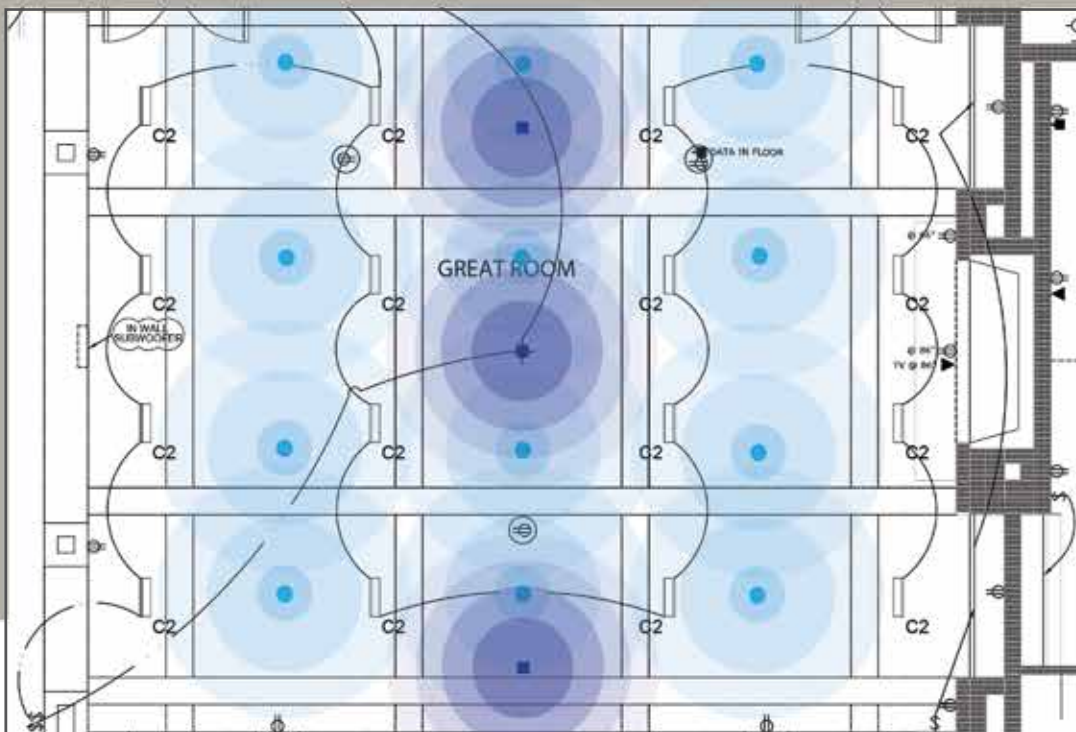

### Indoor and Commercial Design

Sonance Design Services provides a custom layout program for all Reference, Visual Performance, Architectural Series, Invisible Series and Professional Series speaker systems. Sonance's Design Services will convert any CAD or house plan into a customized layout for each audio zone showing the best possible placement for all speakers and subwoofers.

# iPort

iPad has become the go-to device to control the app-driven connected home. We believe that by creating ways to hold, charge and protect it, iPad transforms into an epic dedicated controller. Whether on the wall in fixed locations or free-floating throughout the home, iPort offers a range charging and mounting systems that add much-needed accessibility to iPad in home control applications.

It gets even better with optional hard buttons embedded in our enclosures that provide instant shortcuts to scenes and key functions for nearly any control system. Say hello to the iPort family of products: enhancing the user experience of the app-driven connected home.

## Hold. Charge. Protect. iPad



# iPort



## LUXEPORT

The next level of iPort charging and mounting  
Available in silver, black and white finishes



Case



BaseStation



Wall Adapter Kit



WallStation



USB Charge Module

### LuxePort Cases

iPad mini 4  
iPad Air, Air 2, Pro 9.7", 5th & 6th Gen  
iPad Pro 10.5"

### LuxePort Charging Stations

WallStation  
BaseStation

### LuxePort Accessories

Wall Adapter Kit  
USB Charge Module

## LAUNCHPORT LAUNCHPORT w/ BUTTONS

Available in black and white finishes



LaunchPort



LaunchPort with Buttons



BaseStation\*



WallStation\*\*

### LaunchPort Sleeves

iPad mini 1, 2, 3, 4  
iPad Air 1, 2, Pro 9.7", 5th & 6th Gen

### LaunchPort Sleeve Buttons

iPad mini 1, 2, 3, 4  
iPad Air 1, 2, Pro 9.7", 5th & 6th Gen

### LaunchPort Charging Stations

LaunchPort WallStation  
LaunchPort BaseStation

\*BaseStation available in black and silver finishes  
\*\*WallStation available in black and white finishes

## CONTROL MOUNT



Control Mount

### Control Mount

iPad mini 1, 2, 3

iPad Air 1, 2,  
Pro 9.7",  
5th & 6th Gen

iPad 1, 2, 3, 4

## SURFACE MOUNT SURFACE MOUNT w/ BUTTONS

Available in silver, black and white finishes



Surface Mount



Surface Mount with Buttons

### Surface Mount System

iPad mini 1, 2, 3, 4  
iPad Air 1, 2, Pro 9.7", 5th & 6th Gen  
iPad Pro 10.5"  
iPad Pro 12.9"

### Surface Mount 6 Buttons System

iPad mini 4  
iPad Air 1, 2, Pro 9.7", 5th & 6th Gen  
iPad Pro 12.9"

### Surface Mount 10 Buttons System

iPad mini 4  
iPad Air 1, 2, Pro 9.7", 5th & 6th Gen  
iPad Pro 12.9"

## xPRESS AUDIO KEYPAD

Direct Control  
for Any Sonos®  
Device over WiFi



xPRESS  
Audio Keypad

### xPRESS Audio Keypad

xPRESS













# Sonance Product Index

## DISTRIBUTED AUDIO

### VISUAL PERFORMANCE

SKU	MODEL	UOM	PAGE
93000	VP42	PR	21
93001	VP46	PR	21
93002	VP48	PR	21
93003	VP62	PR	21
93004	VP66	PR	21
93005	VP68	PR	21
93006	VP82	PR	21
93007	VP86	PR	21
93008	VP88	PR	21
93117	VP38R	EA	21
93009	VP42R	PR	21
93010	VP46R	PR	21
93011	VP48R	PR	21
93088	VP60R	PR	21
93012	VP62R	PR	21
93013	VP64R	PR	21
93014	VP66R	PR	21
93015	VP68R	PR	21
93089	VP80R	PR	21
93016	VP82R	PR	21
93017	VP86R	PR	21
93018	VP88R	PR	21
93120	VP3SQ Square Adapter & Grille	EA	21
93029	VP4SQ Square Adapter & Grille	PR	21
93030	VP6SQ Square Adapter & Grille	PR	21
93031	VP8SQ Square Adapter & Grille	PR	21
93019	VP66 TL	PR	21
93020	VP62R TL	PR	21
93021	VP66R TL	PR	21
93022	VP62R SST/SUR TL	EA	21
93368	VP52R UTL	PR	21
93338	VPXT6	PR	22
93339	VPXT6R	PR	22
93340	VPXT6R SST	EA	22
93341	VPXT8R	PR	22
93342	VPXT6SQ Square Adapter & Grille	PR	22
93343	VPXT8SQ Square Adapter & Grille	PR	22
93028	VP62 LCR	EA	22
93084	VP66 LCR	EA	22
93023	VP46R SST/SUR	EA	22
93024	VP62R SST/SUR	EA	22
93025	VP66R SST/SUR	EA	22
93026	VP86R SST/SUR	EA	22
93027	VP66 SST/SUR	EA	22
93044	BPS8	EA	22
93097	VPBPC6R	EA	22
93324	BPS6 TL	EA	22
93334	VPBPC3R TL	EA	22
93043	BPS6	EA	22
93118	VPBPC3R	EA	22
93353	VPSUB	EA	22
92741	VP85R W	EA	22
92740	VP85 W	EA	22

### INVISIBLE SERIES

92965	IS2	PR	26
92966	IS4	PR	26
92967	ISW	EA	26
92968	IS4 SST	EA	26
40127	IS4 C	EA	26
92969	IS2 Small Enclosure	EA	26
92970	IS4, IS4 SST, ISW Large Enclosure	EA	26
92722	IS2 Small Space Saver	EA	26
92723	IS4, IS4 SST, ISW Large Space Saver	EA	26

## DISTRIBUTED AUDIO CONTINUED

### ARCHITECTURAL SERIES

SKU	MODEL	UOM	PAGE
93041	AS38RS	EA	24
93042	AS68RS	EA	24
93044	BPS8	EA	24
93074	ASBPC6RS	EA	24
93049	1/2" Medium Gypsum Mounting Platform Round	EA	24
93050	1/2" Medium Gypsum Mounting Platform Square	EA	24
93051	5/8" Medium Gypsum Mounting Platform Round	EA	24
93052	5/8" Medium Gypsum Mounting Platform Square	EA	24
93055	5/8" Solid Surface Medium Mounting Platform Round & Square	EA	24
93324	BPS6 TL	EA	24
93335	ASBPC3RS TL Trim Ring & Grilles	EA	24
93362	1/2" Discreet Gypsum Mounting Platform Round TL	EA	24
93363	1/2" Discreet Gypsum Mounting Platform Square TL	EA	24
93364	5/8" Discreet Gypsum Mounting Platform Round TL	EA	24
93365	5/8" Discreet Gypsum Mounting Platform Square TL	EA	24
93043	BPS6	EA	24
93073	ASBPC3RS	EA	24
93045	1/2" Discreet Gypsum Mounting Platform Round	EA	24
93046	1/2" Discreet Gypsum Mounting Platform Square	EA	24
93047	5/8" Discreet Gypsum Mounting Platform Round	EA	24
93048	5/8" Discreet Gypsum Mounting Platform Square	EA	24
93053	5/8" Solid Surface Discreet Mounting Platform Round & Square	EA	24

### C SERIES

93124	C6R	PR	21
93125	C6R SST	EA	21

### AMPLIFIERS

93091	SONAMP 2-100	EA	28
92446	SONAMP ASAP3D SE	EA	28
93092	SONAMP 12-50	EA	28
93378	DSP 2-150 MKII	EA	28
93379	DSP 2-750 MKII	EA	28
93331	DSP 8-130 MKII	EA	28
93135	SR 2-125	EA	28
93099	Digital Input Module	EA	28

### VISUAL PERFORMANCE ACCESSORIES

92246	Large Rectangle Flex Bracket	5PR	-
92336	Medium Rectangle Flex Bracket	5PR	-
92470	Small Rectangle Flex Bracket	5PR	-
92247	Large Round Flex Bracket	5PR	-
92337	Medium Round Flex Bracket	5PR	-
92471	Small Round Flex Bracket	5PR	-
92344	Medium Square Flex Bracket	5PR	-
92475	Medium LCR Flex Bracket	EA	-
92066	Medium Rectangle Masonry Bracket	PR	-
92067	Small Rectangle Masonry Bracket	PR	-
91708	Large Rectangle Acoustic Enclosure	EA	-
91687	Medium Rectangle Acoustic Enclosure	EA	-
91900	Large Round Acoustic Enclosure	EA	-
91688	Medium Round Acoustic Enclosure	EA	-
92242	Large Rectangle Retrofit Enclosure	PR	-
92342	Medium Rectangle Retrofit Enclosure	PR	-
92442	Small Rectangle Retrofit Enclosure	PR	-
92243	Large Round and SQ Retrofit Enclosure	PR	-
92343	Medium Round and SQ Retrofit Enclosure	PR	-
92443	Small Round and SQ Retrofit Enclosure	PR	-
92836	Medium LCR Retrofit Enclosure	EA	-

# Sonance Product Index

## SURROUND SOUND

### REFERENCE

SKU	MODEL	UOM	PAGE
93344	R1	EA	30
93345	R1SUR	EA	30
93346	R2	EA	30
93347	R2SUR	EA	30
93348	R1CAB	EA	30
93351	R1C	EA	30
93352	R1CSUR	EA	30
93354	R10SUB	EA	32
93355	R12SUB	EA	32
92874	R10SUB ENC	EA	32
92875	R12SUB ENC	EA	32
93376	R10SUB ENC System	EA	32
93377	R12SUB ENC System	EA	32

### VISUAL PERFORMANCE

93023	VP46R SST/SUR	EA	22
93024	VP62R SST/SUR	EA	22
93025	VP66R SST/SUR	EA	22
93026	VP86R SST/SUR	EA	22
93027	VP66 SST/SUR	EA	22

### SOUNDBAR

93425	SB46-55	EA	38
93426	SB46-65	EA	38
93427	SB46-75	EA	38
93428	SB46-85	EA	38
93086	SB46M	EA	38
93087	SB46L	EA	38

### CABINET SUBWOOFERS

93356	i8	EA	34
93357	i10	EA	34
93358	i12	EA	34
93359	D8 BLK	EA	36
93374	D8 WHT	EA	36
93360	Wireless Transmitter	EA	34

## COMMERCIAL

### PROFESSIONAL SERIES

40130	PS-C43RT	PR	52
40131	PS-C63RT	PR	52
40132	PS-C83RT	PR	52
40133	PS-C83RWT	EA	52
40181	PS-C43RTLTP	PR	52
40182	PS-C63RTLTP	PR	52
40147	PS-S43T BLK	PR	52
40142	PS-S43T WHT	PR	52
40148	PS-S53T BLK	PR	52
40143	PS-S53T WHT	PR	52
40149	PS-S63T BLK	PR	52
40144	PS-S63T WHT	PR	52
40150	PS-S83T BLK	PR	52
40145	PS-S83T WHT	PR	52
40151	PS-S83WT BLK	EA	52
40146	PS-S83WT WHT	EA	52
40138	PS-P43T BLK	PR	52
40134	PS-P43T WHT	PR	52
40139	PS-P63T BLK	PR	52
40135	PS-P63T WHT	PR	52
40140	PS-P83T BLK	PR	52
40136	PS-P83T WHT	PR	52
40141	PS-P83WT BLK	EA	52
40137	PS-P83WT WHT	EA	52
40127	IS4 C	EA	52

## OUTDOOR

### SONANCE LANDSCAPE SERIES

SKU	MODEL	UOM	PAGE
93369	LS4T SAT	EA	42
93370	LS6T SAT	EA	42
93371	LS12T SUB	EA	42
93372	LS15T SUB	EA	42
93373	HS12T SUB	EA	42

### SONANCE LANDSCAPE SERIES 70V SYSTEMS

93382	LS4T SAT/LS12T 8.1 SYSTEM w/ DSP	EA	-
93409	LS4T SAT/LS12T 8.2 SYSTEM w/ DSP	EA	-
93410	LS6T SAT/LS12T 6.1 SYSTEM w/ DSP	EA	-
93411	LS6T SAT/LS12T 8.2 SYSTEM w/ DSP	EA	-
93412	LS6T SAT/LS15T 8.1 SYSTEM w/ DSP	EA	-

### SONANCE LANDSCAPE SERIES 8 OHM SYSTEMS

93383	LS6T SAT/LS12T 4.1 SYSTEM w/ 2 DSP 2-750 MKII	EA	-
93413	LS6T SAT/LS12T 4.1 SYSTEM w/ 2 DSP 2-150 MKII	EA	-

### SONANCE LANDSCAPE SERIES 70V SYSTEMS

92925	Ground Post 19"	EA	-
92924	Ground Stake 9"	EA	-
92927	Tree Mount	EA	-
92926	Surface Mount	EA	-

### SONARRAY

93134	Sonarray SR1 System + Amplifier	EA	46
92983	Sonarray SR1 System	EA	46
93135	SR 2-125 Amplifier	EA	46
93139	SR1 SUB	EA	46
93405	SR1 SAT 4-Pack	EA	46

### VP EXTREME

93338	VPXT6	PR	50
93339	VPXT6R	PR	50
93340	VPXT6R SST	EA	50
93341	VPXT8R	PR	50
93342	VPXT6SQ Square Adapter & Grille	PR	50
93343	VPXT8SQ Square Adapter and Grille	PR	50

### MARINERS

93148	Mariner 54 WHT	PR	51
93149	Mariner 54 BLK	PR	51
93150	Mariner 56 WHT	PR	51
93151	Mariner 56 BLK	PR	51
93152	Mariner 64 WHT	PR	51
93153	Mariner 64 BLK	PR	51
93154	Mariner 66 WHT	PR	51
93155	Mariner 66 BLK	PR	51
93156	Mariner 86 WHT	PR	51
93157	Mariner 86 BLK	PR	51
93158	Mariner 54 SST WHT	EA	51
93159	Mariner 54 SST BLK	EA	51
93160	Mariner 64 SST WHT	EA	51
93161	Mariner 64 SST BLK	EA	51

### ROCKS

92743	RK63 Granite	PR	51
92744	RK63 Brown	PR	51
92745	RK83 Granite	PR	51
92746	RK83 Brown	PR	51
92887	RK10W Woofer Granite	EA	51
92888	RK10W Woofer Brown	EA	51



# iPort Product Index

## iPORT

### CONTROL MOUNT

SKU	MODEL	UOM	PAGE
70094	Control Mount (iPad Mini 1, 2, 3)	EA	58
70095	Control Mount BLK (iPad Air 1, 2, Pro 9.7", 5 <sup>th</sup> & 6 <sup>th</sup> Gen)	EA	58
70093	Control Mount (iPad 1, 2, 3, 4)	EA	58

### LAUNCHPORT

SKU	MODEL	UOM	PAGE
70158	LP Base Station BLK	EA	58
70141	LP Base Station SLV	EA	58
70170	LP Wall Station BLK	EA	58
70142	LP Wall Station WHT	EA	58
70304	AM.2 LP Sleeve BLK (iPad Mini 1, 2, 3, 4)	EA	58
70305	AM.2 LP Sleeve WHT (iPad Mini 1, 2, 3, 4)	EA	58
70300	AP.5 LP Sleeve BLK (iPad Air 1, 2, Pro 9.7", 5 <sup>th</sup> & 6 <sup>th</sup> Gen)	EA	58
70301	AP.5 LP Sleeve WHT (iPad Air 1, 2, Pro 9.7", 5 <sup>th</sup> & 6 <sup>th</sup> Gen)	EA	58

### LAUNCHPORT SLEEVE W/ BUTTONS

SKU	MODEL	UOM	PAGE
70306	AM.2 LP Sleeve w/Buttons BLK (iPad Mini 1, 2, 3, 4)	EA	58
70307	AM.2 LP Sleeve w/Buttons WHT (iPad Mini 1, 2, 3, 4)	EA	58
70302	AP.5 LP Sleeve w/Buttons BLK (iPad Air 1, 2, Pro 9.7", 5 <sup>th</sup> & 6 <sup>th</sup> Gen)	EA	58
70303	AP.5 LP Sleeve w/Buttons WHT (iPad Air 1, 2, Pro 9.7", 5 <sup>th</sup> & 6 <sup>th</sup> Gen)	EA	58

### LUXEPORT

SKU	MODEL	UOM	PAGE
71000	LuxePort Base Station BLK	EA	58
71002	LuxePort Base Station WHT	EA	58
71001	LuxePort Base Station SLV	EA	58
71003	LuxePort Wall Station BLK	EA	58
71005	LuxePort Wall Station WHT	EA	58
71004	LuxePort Wall Station SLV	EA	58
71009	LuxePort BLK (iPad Mini 4)	EA	58
71011	LuxePort WHT (iPad Mini 4)	EA	58
71010	LuxePort SLV (iPad Mini 4)	EA	58
71012	LuxePort BLK (iPad Air, Air 2, Pro 9.7", 5 <sup>th</sup> & 6 <sup>th</sup> Gen)	EA	58
71014	LuxePort WHT (iPad Air, Air 2, Pro 9.7", 5 <sup>th</sup> & 6 <sup>th</sup> Gen)	EA	58
71013	LuxePort SLV (iPad Air, Air 2, Pro 9.7", 5 <sup>th</sup> & 6 <sup>th</sup> Gen)	EA	58
71015	LuxePort BLK (iPad Pro 10.5")	EA	58
71017	LuxePort WHT (iPad Pro 10.5")	EA	58
71016	LuxePort SLV (iPad Pro 10.5")	EA	58
71006	LuxePort Wall Adapter Kit BLK	EA	58
71008	LuxePort Wall Adapter Kit WHT	EA	58
71007	LuxePort Wall Adapter Kit SLV	EA	58
71018	LuxePort USB Charge Module BLK	EA	58
71020	LuxePort USB Charge Module WHT	EA	58
71019	LuxePort USB Charge Module SLV	EA	58

### SURFACE MOUNT

SKU	MODEL	UOM	PAGE
70700	Surface Mount BLK (iPad Mini 1, 2, 3)	EA	58
70702	Surface Mount WHT (iPad Mini 1, 2, 3)	EA	58
70701	Surface Mount SLV (iPad Mini 1, 2, 3)	EA	58
70722	Surface Mount BLK (iPad Mini 4)	EA	58
70724	Surface Mount WHT (iPad Mini 4)	EA	58
70723	Surface Mount SLV (iPad Mini 4)	EA	58
70703	Surface Mount BLK (iPad Air 1, 2, Pro 9.7", 5 <sup>th</sup> & 6 <sup>th</sup> Gen)	EA	58
70705	Surface Mount WHT (iPad Air 1, 2, Pro 9.7", 5 <sup>th</sup> & 6 <sup>th</sup> Gen)	EA	58
70704	Surface Mount SLV (iPad Air 1, 2, Pro 9.7", 5 <sup>th</sup> & 6 <sup>th</sup> Gen)	EA	58
70796	Surface Mount BLK (iPad Pro 10.5")	EA	58
70798	Surface Mount WHT (iPad Pro 10.5")	EA	58
70797	Surface Mount SLV (iPad Pro 10.5")	EA	58
70743	Surface Mount BLK (iPad Pro 12.9")	EA	58

### SURFACE MOUNT CONTINUED

SKU	MODEL	UOM	PAGE
70745	Surface Mount WHT (iPad Pro 12.9")	EA	58
70744	Surface Mount SLV (iPad Pro 12.9")	EA	58
70719	PoE Injector	EA	58
70718	PoE Splitter	EA	58
70720	Glass Mounting Kit	EA	58

### SURFACE MOUNT W/ BUTTONS

SKU	MODEL	UOM	PAGE
70764	SM w/6 Buttons BLK (iPad Mini 1, 2, 3, 4)	EA	58
70766	SM w/6 Buttons WHT (iPad Mini 1, 2, 3, 4)	EA	58
70765	SM w/6 Buttons SLV (iPad Mini 1, 2, 3, 4)	EA	58
70758	SM w/10 Buttons BLK (iPad Mini 1, 2, 3, 4)	EA	58
70760	SM w/10 Buttons WHT (iPad Mini 1, 2, 3, 4)	EA	58
70759	SM w/10 Buttons SLV (iPad Mini 1, 2, 3, 4)	EA	58
70767	SM w/6 Buttons BLK (iPad Air 1, 2, Pro 9.7", 5 <sup>th</sup> & 6 <sup>th</sup> Gen)	EA	58
70769	SM w/6 Buttons WHT (iPad Air 1, 2, Pro 9.7", 5 <sup>th</sup> & 6 <sup>th</sup> Gen)	EA	58
70768	SM w/6 Buttons SLV (iPad Air 1, 2, Pro 9.7", 5 <sup>th</sup> & 6 <sup>th</sup> Gen)	EA	58
70761	SM w/10 Buttons BLK (iPad Air 1, 2, Pro 9.7", 5 <sup>th</sup> & 6 <sup>th</sup> Gen)	EA	58
70763	SM w/10 Buttons WHT (iPad Air 1, 2, Pro 9.7", 5 <sup>th</sup> & 6 <sup>th</sup> Gen)	EA	58
70762	SM w/10 Buttons SLV (iPad Air 1, 2, Pro 9.7", 5 <sup>th</sup> & 6 <sup>th</sup> Gen)	EA	58
70778	SM w/6 Buttons BLK (iPad Pro 12.9")	EA	58
70780	SM w/6 Buttons WHT (iPad Pro 12.9")	EA	58
70779	SM w/6 Buttons SLV (iPad Pro 12.9")	EA	58
70781	SM w/10 Buttons BLK (iPad Pro 12.9")	EA	58
70783	SM w/10 Buttons WHT (iPad Pro 12.9")	EA	58
70782	SM w/10 Buttons SLV (iPad Pro 12.9")	EA	58
70719	PoE Injector	EA	58
70718	PoE Splitter	EA	58

### xPRESS

SKU	MODEL	UOM	PAGE
70800	xPRESS Keypad	EA	58



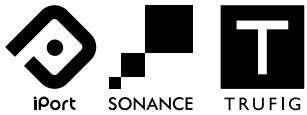

©2018 Dana Innovations. All rights reserved. Sonance, iPort and TRUFIG are registered trademarks of Dana Innovations.

Due to continuous product improvement, all features and specifications are subject to change without notice.  
For the latest Sonance product specification information visit our website: [www.sonance.com](http://www.sonance.com)